

1. Buildings are to be tied into the town sewer
2. The parking area surface is currently black r.a.p.
3. The parking area and Arch Avenue will be improved and maintained with black r.a.p., 35% surface infiltration is assumed for these areas.
4. Based on experience with soils in the area, the proposed system should handle a 25-year rain storm event through storage and infiltration
5. All drainage structures to be designed and constructed to handle H-20 loading, all piping to be 6" sch 80 unless noted otherwise
7. Outlet tees extending to 30" above bottom to be provided at catch basin

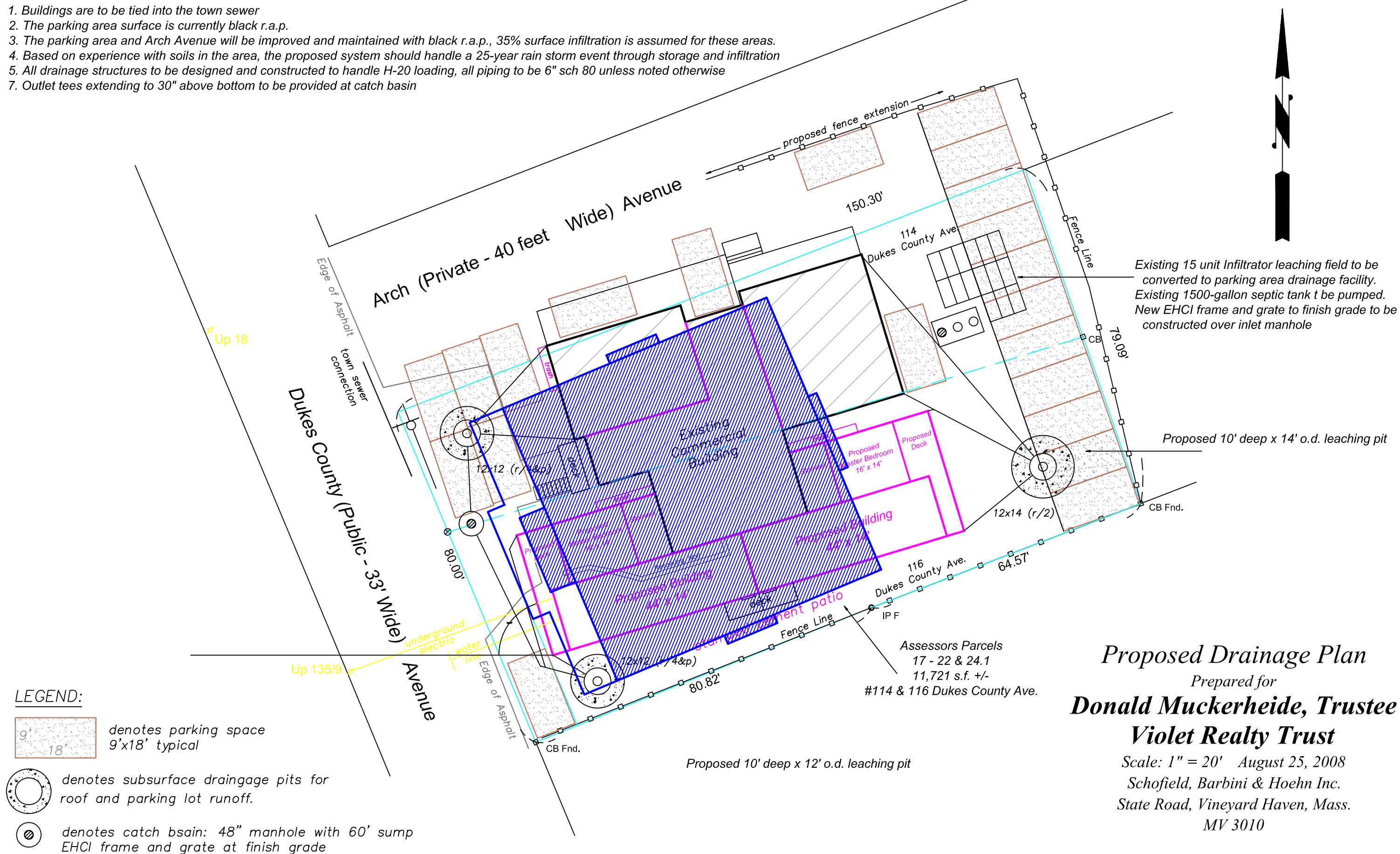

Scale: 1" = 20' August 25, 2008  
Schofield, Barbini & Hoehn Inc.  
State Road, Vineyard Haven, Mass.  
MV 3010