



1 Cedar Street  
Suite 400  
Providence, RI 02903  
401.272.8100

**PLANT SCHEDULE**

DECIDUOUS TREES	QTY	BOTANICAL NAME	COMMON NAME	SIZE
AR	9	Acer rubrum 'October Glory'	'October Glory' Red Maple	2 1/2 - 3" CAL.
ZP	2	Quercus palustris	Pin Oak	2 1/2 - 3" CAL.
QP	5	Zelkova serrata 'Green Vase'	Green Vase Zelkova	2 1/2 - 3" CAL.
EVERGREEN TREES	QTY	BOTANICAL NAME	COMMON NAME	SIZE
IN	9	Ilex x 'Nellie R Stevens'	Nellie Stevens Holly	15 GAL.
JE	18	Juniperus virginiana	Eastern Red Cedar	5 - 6' HT.
FLOWERING TREES	QTY	BOTANICAL NAME	COMMON NAME	SIZE
PK	9	Prunus serrulata 'Kwanzan'	Kwanzan Cherry	2 1/2 - 3" CAL.
SP	3	Stewartia pseudocamellia	Japanese Stewartia	7 - 8' HT.

**PLANT SCHEDULE**

SHRUBS	QTY	BOTANICAL NAME	COMMON NAME	SIZE	
AD	95	Azalea x 'Delaware Valley White'	Delaware Valley White Azalea	18 - 24" SPD	
CA	34	Clethra alnifolia	Summersweet	18 - 24" HT.	
DG	7	Deutzia gracilis	Slender Deutzia	18 - 24" SPD	
HES	21	Hydrangea macrophylla 'Endless Summer' TM	Endless Summer Hydrangea	#3 POT	
HB	18	Hydrangea paniculata 'Bobo'	Bobo Hydrangea	#3 POT	
IC	62	Ilex crenata 'Compacta'	Compact Japanese Holly	18 - 24" SPD	
IS	9	Ilex crenata 'Sky Pencil'	Sky Pencil Japanese Holly	3 - 4' HT.	
IGC	49	Ilex glabra 'Compacta'	Compact Inkberry	2 - 3' HT.	
IVS	22	Ilex verticillata 'Sparkleberry'	Sparkleberry Winterberry	2 - 3' HT.	
ID	6	Ilex x messerveye 'Dragon Lady'	Dragon Lady Meserve Holly	#7 POT	
MP	25	Myrica pensylvanica	Northern Bayberry	2 - 3' HT.	
RP	28	Rhododendron var. 'PJM'	PJM Rhododendron	2 - 2 1/2' HT.	
RAG	16	Rhus aromatica Gro-low	Gro-Low Fragrant Sumac	18 - 24" SPD	
RK	15	Rosa x 'Knockout'	Knock-Out Rose	#3 POT	
RF	54	Rosa x 'The Fairy'	The Fairy Rose	#3 POT	
SLP	54	Spiraea x bumalda 'Little Princess'	Little Princess Spiraea	18 - 24" SPD	
TG	48	Taxus cuspidata 'Greenwave'	Greenwave Yew	2 - 2 1/2' SPD	
GROUND COVERS	QTY	BOTANICAL NAME	COMMON NAME	SIZE	SPACING
HE	187	Hedera helix	English Ivy	Bare Root	12" o.c.
ORNAMENTAL GRASSES	QTY	BOTANICAL NAME	COMMON NAME	SIZE	SPACING
PVS	26	Panicum virgatum 'Shenandoah'	Shenandoah Switch Grass	#1 POT	36" o.c.
PAH	82	Pennisetum alopecuroides 'Hamel'	Hamel Dwarf Fountain Grass	#1 POT	30" o.c.
PERENNIALS	QTY	BOTANICAL NAME	COMMON NAME	SIZE	SPACING
AMA	11	Achillea millefolium 'Apple Blossom'	Apple Blossom Yarrow	#1 POT	18" o.c.
ANA	23	Aster novae-angliae 'Alma Potschke'	Alma Potschke New England Aster	#1 POT	24" o.c.
ES	8	Echinacea purpurea 'Ruby Star'	Ruby Star Coneflower	#1 POT	24" o.c.
HHR	52	Hemerocallis x 'Happy Returns'	Happy Returns Daylily	#1 POT	24" o.c.
HRR	122	Hemerocallis x 'Rosy Returns'	Rosy Returns Daylily	#1 POT	24" o.c.
NW	17	Nepeta x faassenii 'Walkers Low'	Walkers Low Catmint	#1 POT	24" o.c.
RFG	25	Rudbeckia fulgida 'Goldsturm'	Goldsturm Black-eyed Susan	#1 POT	24" o.c.

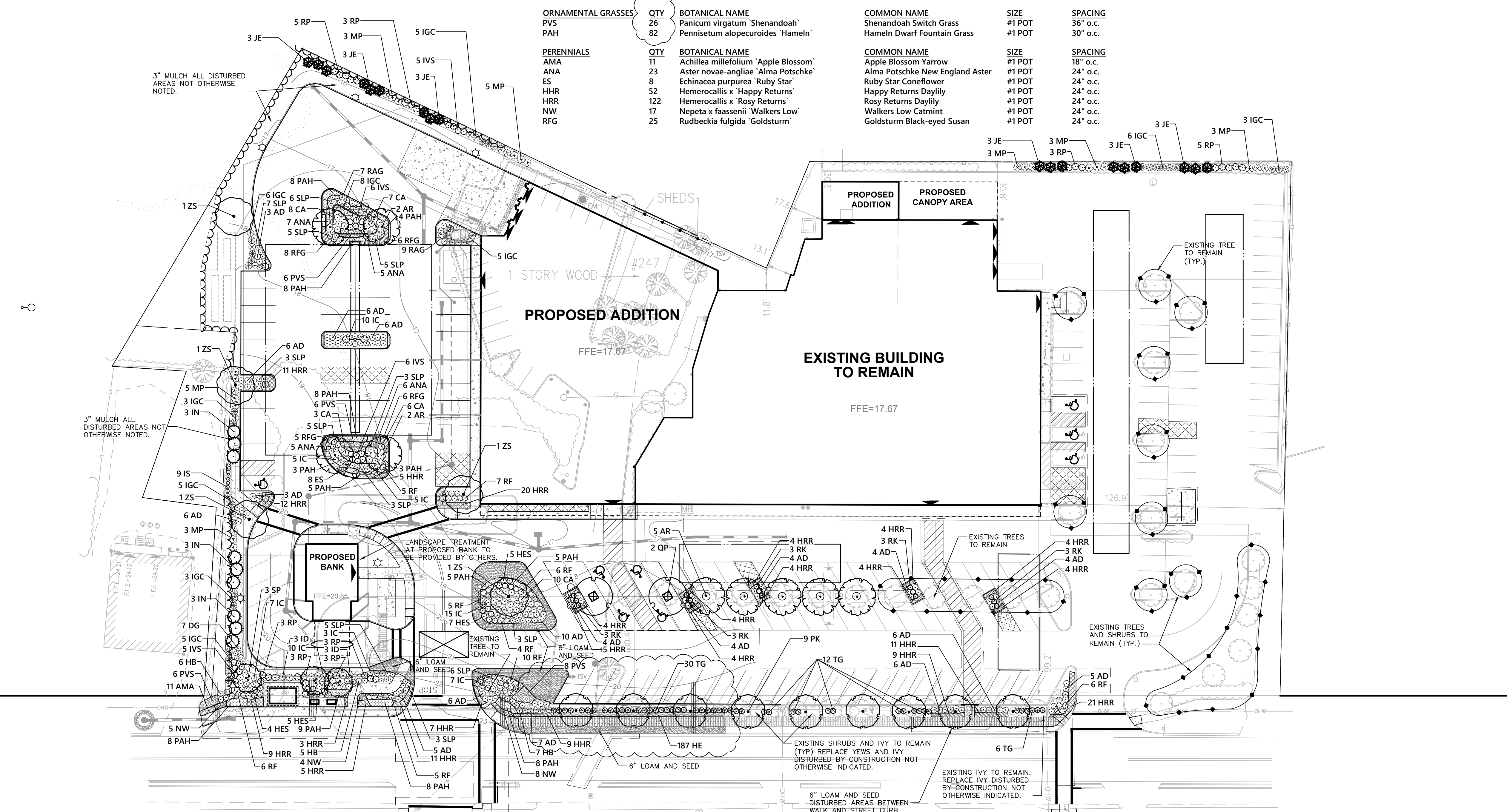

**Edgartown Stop & Shop Expansion**

235-257 Upper Main Street  
Edgartown, Massachusetts

No.	Revision	Date	Aspd.
4	SIDEWALK CONNECTION REMOVAL	12/09/19	RLC
3	PLANS ISSUED FOR BID	5/10/19	RLC
-	INTERNAL REVIEW REVS	OCT 30, 2018	KML
-	PER E. B. C. REVIEW FINAL COMMENTS	OCT 19, 2018	KML
2	SUBMISSION TO MVC	6/30/17	RLC
1	SUBMISSION TO LUPC	2/22/17	RLC

Designed by: \_\_\_\_\_ Date: \_\_\_\_\_  
Issued for: **Permitting** Date: **Oct. 11, 2016**

**Not Approved for Construction**

Drawing Title  
**Planting Plan**  
Drawing Number

**Plant Maintenance Notes**

- CONTRACTOR SHALL PROVIDE COMPLETE MAINTENANCE OF THE LAWNS AND PLANTINGS. NO IRRIGATION IS PROPOSED FOR THIS SITE. THE CONTRACTOR SHALL SUPPLY SUPPLEMENTAL WATERING FOR NEW LAWNS AND PLANTINGS DURING THE ONE YEAR PLANT GUARANTEE PERIOD.
- CONTRACTOR SHALL PROVIDE ALL MATERIALS, LABOR, AND EQUIPMENT FOR THE COMPLETE LANDSCAPE MAINTENANCE WORK. WATER SHALL BE PROVIDED BY THE CONTRACTOR.
- WATERING SHALL BE REQUIRED DURING THE GROWING SEASON, WHEN NATURAL RAINFALL IS BELOW ONE INCH PER WEEK.
- WATER SHALL BE APPLIED IN SUFFICIENT QUANTITY TO THOROUGHLY SATURATE THE SOIL IN THE ROOT ZONE OF EACH PLANT.
- CONTRACTOR SHALL REPLACE DEAD OR DYING PLANTS AS DIRECTED BY OWNER'S REPRESENTATIVE DURING THE GUARANTEE PERIOD, AND AS REQUIRED AT THE END OF THE ONE YEAR GUARANTEE PERIOD. CONTRACTOR SHALL TURN OVER MAINTENANCE TO THE FACILITY MAINTENANCE STAFF AFTER THE END OF THE GUARANTEE PERIOD.
- LONG-TERM MAINTENANCE: NEWLY PLANTED CHERRY TREES ALONG UPPER MAIN ST. SHALL BE MAINTAINED WITH YEARLY PRUNING CONFORMING TO ANSI A300 STANDARDS, TO ESTABLISH THEIR SHAPE AND TO MAINTAIN THE TREES TO BE LOWER THAN THE OVERHEAD WIRES. ALL TREES SHALL BE MAINTAINED AT THE SAME HEIGHT, BASED ON CLEARING THE LOWEST OVERHEAD WIRE.

**Planting Notes**

- ALL PROPOSED PLANTING LOCATIONS SHALL BE STAKED AS SHOWN ON THE PLANS FOR FIELD REVIEW AND APPROVAL BY THE LANDSCAPE ARCHITECT PRIOR TO INSTALLATION.
- CONTRACTOR SHALL VERIFY LOCATIONS OF ALL BELOW GRADE AND ABOVE GROUND UTILITIES AND NOTIFY OWNERS REPRESENTATIVE OF CONFLICTS.
- NO PLANT MATERIALS SHALL BE INSTALLED UNTIL ALL GRADING AND CONSTRUCTION HAS BEEN COMPLETED IN THE IMMEDIATE AREA. CONTRACTOR SHALL NOTIFY OWNER'S REPRESENTATIVE OF ANY CONFLICT.
- A 3-INCH DEEP MULCH PER SPECIFICATION SHALL BE INSTALLED UNDER ALL TREES AND SHRUBS, AND IN ALL PLANTING BEDS, UNLESS OTHERWISE INDICATED ON THE PLANS, OR AS DIRECTED BY OWNER'S REPRESENTATIVE.
- ALL TREES SHALL BE BALLED AND BURLAPPED, UNLESS OTHERWISE NOTED IN THE DRAWINGS OR SPECIFICATION, OR APPROVED BY THE OWNER'S REPRESENTATIVE.
- FINAL QUANTITY FOR EACH PLANT TYPE SHALL BE AS GRAPHICALLY SHOWN ON THE PLAN. THIS NUMBER SHALL TAKE PRECEDENCE IN CASE OF ANY DISCREPANCY BETWEEN QUANTITIES SHOWN ON THE PLANT LIST AND ON THE PLAN. THE CONTRACTOR SHALL REPORT ANY DISCREPANCIES BETWEEN THE NUMBER OF PLANTS SHOWN ON THE PLANT LIST AND PLANT LABELS PRIOR TO BIDDING.
- ANY PROPOSED PLANT SUBSTITUTIONS MUST BE REVIEWED BY LANDSCAPE ARCHITECT AND APPROVED IN WRITING BY THE OWNER'S REPRESENTATIVE.
- ALL PLANT MATERIALS INSTALLED SHALL MEET THE SPECIFICATIONS OF THE "AMERICAN STANDARDS FOR NURSERY STOCK" BY THE AMERICAN ASSOCIATION OF NURSERYMEN, AND THE CONTRACT DOCUMENTS.
- ALL PLANT MATERIALS SHALL BE GUARANTEED FOR ONE YEAR FOLLOWING DATE OF FINAL ACCEPTANCE. ALL PLANT MATERIAL SHALL SHOW MINIMUM 85% HEALTHY GROWTH AND TYPICAL PLANT SHAPE AND HABIT AT THE END OF THE GUARANTEE PERIOD. TREES WITH DEAD LEADERS SHALL BE REPLACED.
- AREAS DESIGNATED "LOAM & SEED" SHALL RECEIVE MINIMUM 6" OF LOAM AND SPECIFIED SEED MIX. LAWNS OVER 2:1 SLOPE SHALL BE PROTECTED WITH EROSION CONTROL FABRIC.
- ALL DISTURBED AREAS NOT OTHERWISE NOTED ON CONTRACT DOCUMENTS SHALL BE LOAM AND SEEDED OR MULCHED AS DIRECTED BY OWNER'S REPRESENTATIVE.
- THIS PLAN IS INTENDED FOR PLANTING PURPOSES. REFER TO SITE / CIVIL DRAWINGS FOR ALL OTHER SITE CONSTRUCTION INFORMATION.

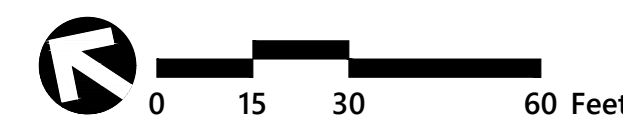

**L-1**

Sheet of  
1 2