

1 LOCATION PLAN
SCALE: 1" = 20'-0"

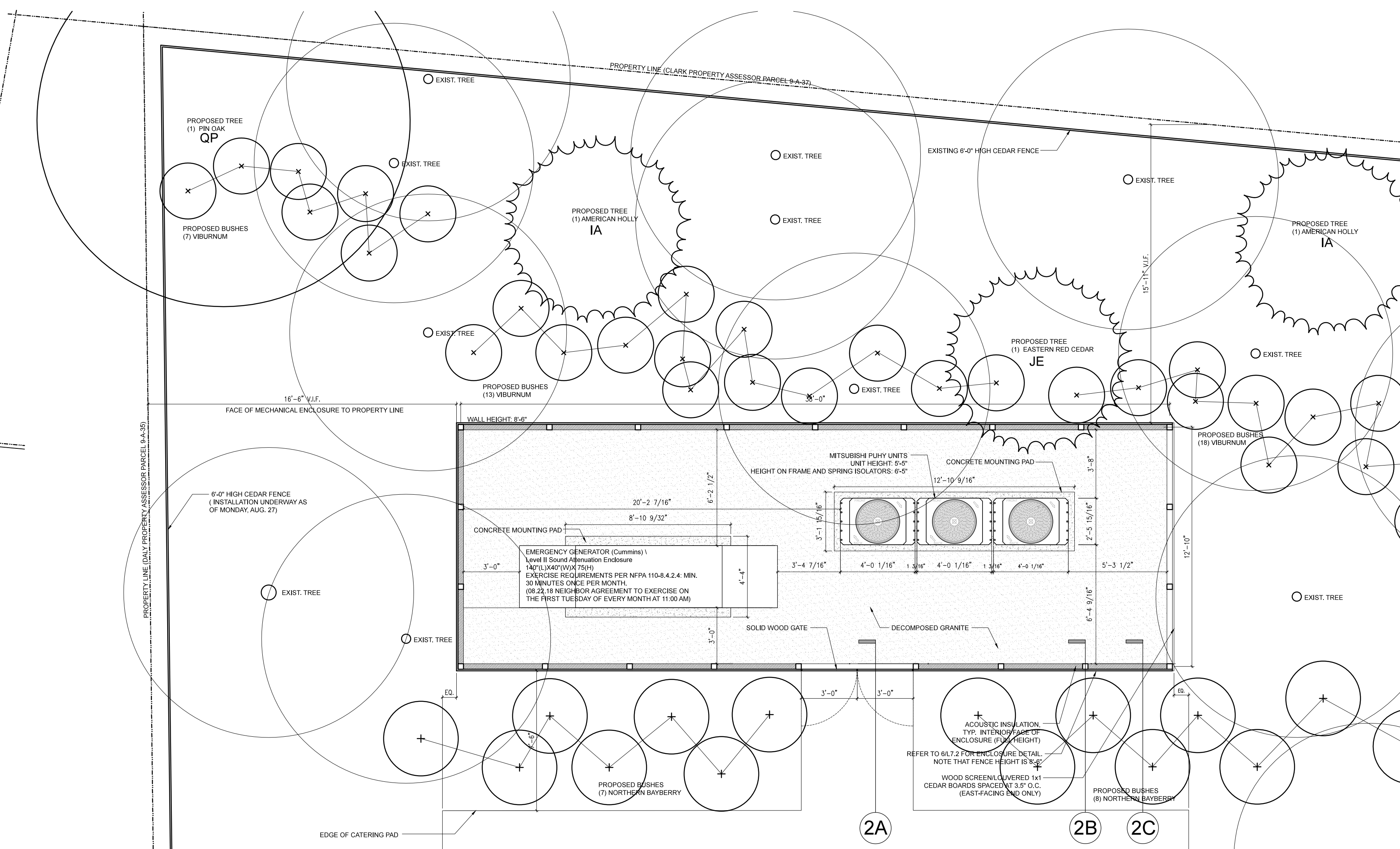

3 PROPOSED OUTDOOR MECHANICAL EQUIPMENT ENCLOSURE
SCALE: 1/4" = 1'-0"

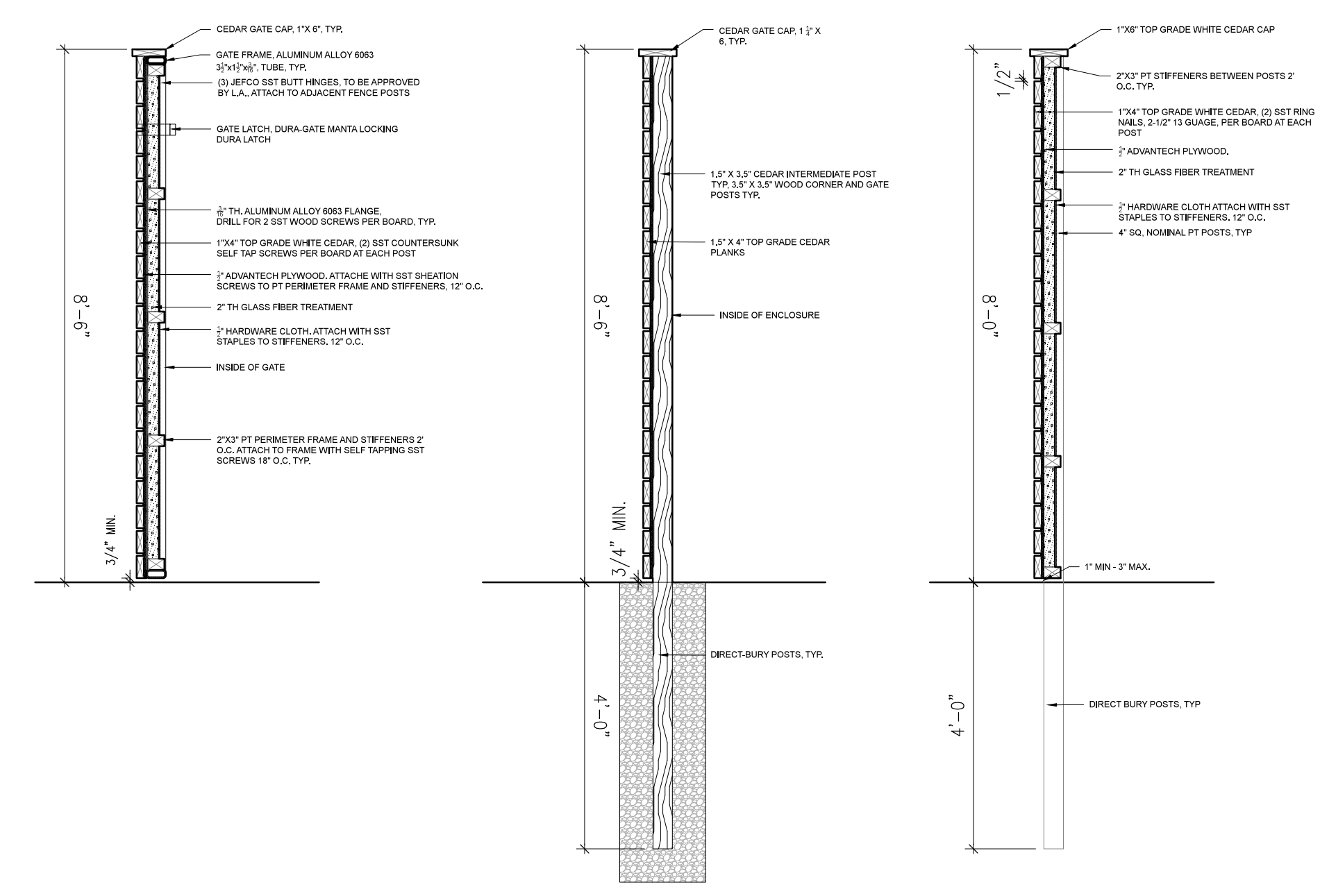

2A. ENCLOSURE GATE SECTION 2B. ENCLOSURE SECTION, AT POST 2C. ENCLOSURE SECTION, TYP.

2 FENCE DETAILS
SCALE: 1/2" = 1'-0"

- NOISE CRITERIA** (per Acentech Memo, Dated July 26, 2018):
1. Measured residual nighttime ambient: **34 dBA**
 2. Presumed residual daytime ambient (accounting for measured construction noise): **40 dBA**
 3. State DEP Requirement: measured residual ambient + 10 dBA (at nighttime, this results in a target of 44 dBA)
 4. **Target Design Team Noise Standard: measured residual ambient + 5 dBA (at nighttime, this results in a target of 39 dBA)**

PROPOSED DESIGN - CONTINUOUSLY OPERATED EQUIPMENT (CONDENSING UNITS):
The equipment enclosure is proposed to be an 8.5 ft high fence systems with sound absorptive material on the inside. There are three condensing units and each is indicated to have a sound emission level of 60 dBA for standard operation, at a distance of 1 meter from the casing of the unit. Based on this, the predicted sound level at the abutter's (Frank Daly) deck for this equipment is about 33 dBA which is actually below the suggested criteria and is also even just below the measured nighttime ambient, which is the most restrictive ambient measurement.

PROPOSED DESIGN - EMERGENCY / DISCONTINUOUSLY OPERATED EQUIPMENT (GENERATOR):
Like the condensing units, the generator will reside within the proposed 8.5 ft high mechanical equipment enclosure. The generator is also provided with a manufacturers' "Level 2" noise reduction enclosure as part of its specification. With the unit's enclosure and the associated engine exhaust muffler, the sound level at 7 meters from the unit in a free field condition is reported to be 75 dBA. For our site and with the planned screen enclosure, the noise level expected for this unit at the Abutter's (Frank Daly) deck is about 57 dBA. This is not an especially high noise level (comparable to an unenclosed residential condensing unit) and will only be heard during emergencies (e.g., time when power is out) and during the required 30-minute equipment exercise once a month. As discussed with the abutters, exercising the generator is scheduled on the first Tuesday of each month at 11:00 AM (See Phil Wallis, memo, dated August 22, 2018).