

Exhibit J

No. REV-36-19

FEE N/A  
Revision

RECEIVED  
JAN 14 2021

COMMONWEALTH OF MASSACHUSETTS

Board of Health, Oak Bluffs, MA.

OB BD OF HEALTH APPLICATION FOR DISPOSAL SYSTEM CONSTRUCTION PERMIT

Application for a Permit to Construct ( ) Repair ( ) Upgrade ( ) Abandon ( ) -  Complete System  Individual Components

|                             |  |
|-----------------------------|--|
| Location <u>38 Wing Rd.</u> | Owner's Name <u>Island Elderly Housing</u> |
| Map/Parcel# <u>17-105</u>   | Address <u>608 Village Rd. 08</u>          |
| Lot#                        | Telephone#                                 |
| Installer's Name            | Designer's Name <u>SBH Inc</u>             |
| Address                     | Address <u>PO BOX 339 UH.</u>              |
| Telephone#                  | Telephone# <u>508 693-2781</u>             |

Type of Building Elderly Housing Facility Lot Size 36.182 sq. ft.  
 Dwelling - No. of Bedrooms \_\_\_\_\_ Garbage grinder ( )  
 Other - Type of Building \_\_\_\_\_ No. of persons \_\_\_\_\_ Showers ( ), Cafeteria ( )  
 Other Fixtures \_\_\_\_\_  
 Design Flow (min. required) 330 gpd Calculated design flow 550 Design flow provided 874 gpd  
 Plan: Date 5/21/2019 Number of sheets \_\_\_\_\_ Revision Date Jan 4, 2021  
 Title proposal away disposal system  
 Description of Soil(s) \_\_\_\_\_  
 Soil Evaluator Form No. \_\_\_\_\_ Name of Soil Evaluator CPR Date of Evaluation 3/5/2019

DESCRIPTION OF REPAIRS OR ALTERATIONS

The undersigned agrees to install the above described Individual Sewage Disposal System in accordance with the provisions of TITLE 5 and further agrees to place the system in operation until a Certificate of Compliance has been issued by the Board of Health.

Signed [Signature] Date Jan 4 2021

Inspections \_\_\_\_\_

No. \_\_\_\_\_

COMMONWEALTH OF MASSACHUSETTS

FEE \_\_\_\_\_

Board of Health, \_\_\_\_\_, MA.

CERTIFICATE OF COMPLIANCE

Description of Work:  Individual Component(s)  Complete System

The undersigned hereby certify that the Sewage Disposal System, Constructed ( ), Repaired ( ), Upgraded ( ), Abandoned ( )

by: \_\_\_\_\_

at: \_\_\_\_\_

has been installed in accordance with the provisions of 310 CMR 15.00 (Title 5) and the approved design plans/as-built plans relating to application No. \_\_\_\_\_, dated \_\_\_\_\_, Approved Design Flow \_\_\_\_\_ (gpd)

Installer: \_\_\_\_\_

Designer: \_\_\_\_\_

Inspector: \_\_\_\_\_

Date: \_\_\_\_\_

The issuance of this permit shall not be construed as a guarantee that the system will function as designed.

REV 36-19

FEE N/A

COMMONWEALTH OF MASSACHUSETTS

Board of Health, Oak Bluffs, MA.

DISPOSAL SYSTEM CONSTRUCTION PERMIT

Permission is hereby granted to: Construct ( ) Repair ( ) Upgrade ( ) Abandon ( ) an individual sewage disposal system at 38 Wing Rd. M17 P105 as described in the application for Disposal System Construction Permit No. REV-36-19, dated 1/14/21.

Provided: Construction shall be completed within three years of the date of this permit. All local conditions must be met.

Date 1/14/21

Board of Health [Signature]

**Project Notes**

- A. No wells were found within 100' of the proposed leaching facility  
 B. Existing cesspool to be abandoned, crushed and backfilled with compacted structural fill  
 C. Underground utilities to be located at start of construction and relocated as required
- Zone II Notes:  
 Locus lies within Zone II of the Form Neck municipal well  
 Lot area: 36,182 sf  
 Allowable flow with advanced treatment 660 GPD x (36,182 sf / 40,000 sf) = 597 GPD > 550 GPD

**Plot Plan**

scale: 1"=40'  
 lot area: 36,182± sq ft

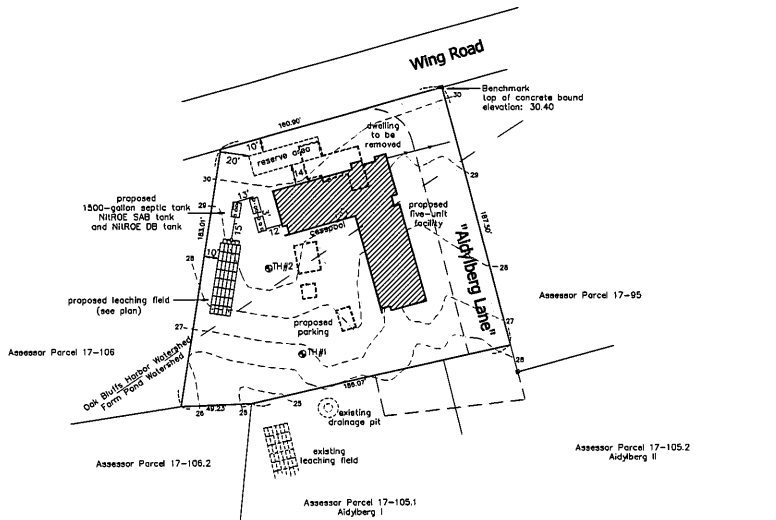

**General Notes**

- Elevations refer to approximate mean sea level datum. See benchmark on plot plan located on top of concrete bound (elevation: 30.40)
- Finished grading to be done in accordance with plot plan.
- Percolation tests to be performed in accordance with the instructions of Title V of the Massachusetts State Environmental Code.
- All construction to conform to Title V and Board of Health requirements.
- Septic tank and distribution box shall be watertight after construction, including covers.
- No driveway, parking or turning area or other impervious areas shall be located above the soil absorption system.
- No permanent structure may be constructed over the 100% expansion area.
- Schofield, Barbini & Hoehn Inc. will not be responsible for the performance of the system unless constructed as shown. Any alterations must be approved in writing by Schofield, Barbini & Hoehn Inc.
- The Board of Health shall require inspection of all construction by the design engineer and by the agent of the Board of Health.
- The design engineer and the system installer shall certify in writing to the approving authority that the system has been constructed in compliance with the approved plans.
- For proper performance, the septic tank should be inspected at least once a year and when the total depth of scum and solids exceed 1/3 the liquid depth of the tank, the tank should be pumped.
- Distribution box cover to be brought to finish grade.

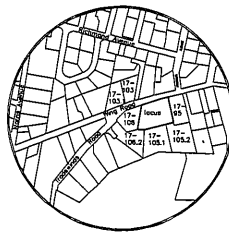

**Profile of System**

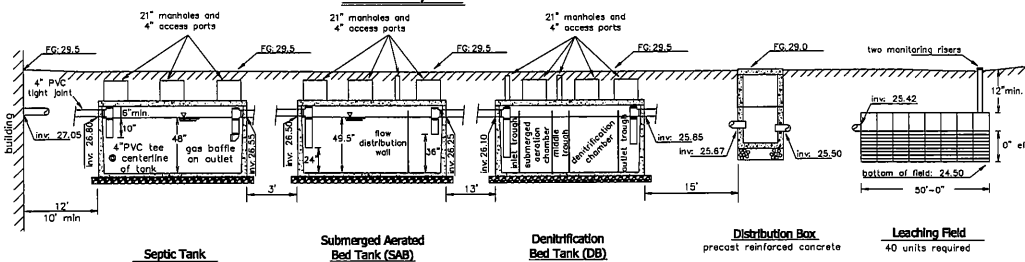

**Plan View of System**

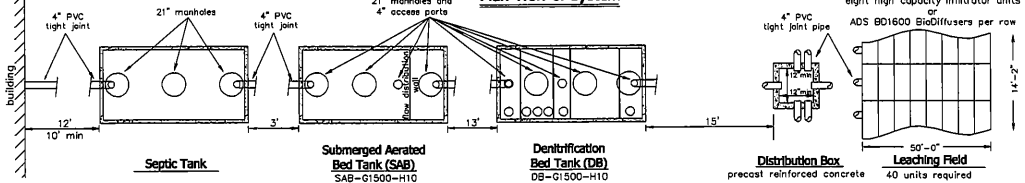

**Typical Leaching Field Cross-Section (no scale)**

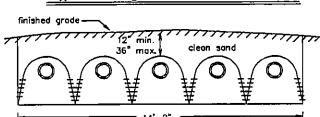

**Leaching Field Detail (no scale)**

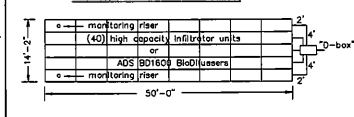

**Schedule of Elevations**

|                                    | finished grade above structure | finished grade above structure |
|------------------------------------|--------------------------------|--------------------------------|
| Top of foundation:                 | 30.50 (varry w/ arch's)        |                                |
| Basement floor:                    | n/s (slab)                     |                                |
| Inverts at foundation:             | 27.05                          | 29.5                           |
| Invert at septic tank inlet:       | 26.80                          |                                |
| Invert at septic tank outlet:      | 26.55                          | 29.5                           |
| Invert at NIROE SAB tank inlet:    | 26.50                          |                                |
| Invert at NIROE SAB tank:          | 26.25                          | 29.5                           |
| Invert at NIROE DB tank inlet:     | 26.10                          |                                |
| Invert at NIROE DB tank outlet:    | 25.85                          | 29.5                           |
| Invert at distribution box inlet:  | 25.67                          |                                |
| Invert at distribution box outlet: | 25.50                          | 29.0                           |
| Invert at infiltrator inlet:       | 25.42                          |                                |
| Elevation of field bottom:         | 24.50                          |                                |

| Deep Test Pit 1 (Surface Elevation: 26.7) |        |                             |          | Deep Test Pit 2 (Surface Elevation: 29.5) |                  |                     |                                | Percolation Test Data |       |    |  |
|---|--------|-----------------------------|----------|---|------------------|---------------------|--------------------------------|-----------------------|-------|----|--|
| Date of Test: March 6, 2019               |        | Date of Test: March 6, 2019 |          | test pit #                                |                  | top of 12" of water |                                | note:                 |       |    |  |
| Depth                                     | Horiz. | Soil Description            | Depth    | Horiz.                                    | Soil Description | date                | depth from top of 12" of water | elevation             | (mpi) |    |  |
| 0"-11"                                    | A      | Loamy SAND                  | 0"-7"    | A   | Loamy SAND       | 1                   | 3/6/19                         | 36"                   | 23.7  | <2 |  |
| 11"-34"                                   | B      | Loamy SAND                  | 7"-33"   | B   | Loamy SAND       | 2                   | 3/6/19                         | 36"                   | 26.5  | <2 |  |
| 34"-132"                                  | C      | SAND                        | 33"-120" | C   | SAND             |                     |                                |                       |       |    |  |

Groundwater was not encountered at a depth of 138" (elevation: 15.2)  
 Groundwater was not encountered at a depth of 120" (elevation: 19.5)

I certify that on April 1, 1995, I have passed the examination approved by the Department of Environmental Protections and that the above analysis has been performed by me consistent with the required training, expertise and experience described in 310 CMR 15.018(2).

**Design Data**

- Estimated Hydraulic Loading: Five units at 110 gallons per day per bedroom = 550 GPD  
Garbage disposal is not allowed with this design.
- Septic Tank Size: Required tank capacity: 550 x 200% = 1100 (minimum)  
Septic tank provided: 1500 gallon MicroFAST 0.9 tank
- Design percolation rate: 2 MPH  
Soil texture: class 1  
Loading rate: 0.74 GPD/SF
- Leaching Area: Total leaching area provided: 708 SF
- Maximum Allowable Loading: 708 SF x 1.67 (chamber general permits) x 0.74 GPD/SF = 874 GPD  
Actual hydraulic loading: 550 GPD

**Legend**

- XX---
  - F.G. = XX.X
  - XX
  - ⊙
  - P.V.C.
  - ⊠
  - E.H.C.I.
  - W
  - E—
  - O.W.—
  - D—
- Denotes proposed contour  
 Denotes proposed finished grade  
 Denotes existing contour  
 Denotes test hole location  
 Denotes polyvinyl chloride pipe, Sch. 40, unless noted  
 Denotes catch basin  
 Denotes extra heavy cast iron  
 Denotes water service  
 Denotes approximate property line  
 Denotes overhead wires  
 Denotes storm drain pipe

**Proposed Sewage Disposal System**

To Serve a Proposed Five-Unit Elderly Housing Facility  
 38 Wing Road Assessor Parcel 17-105  
 Oak Bluffs, Massachusetts

Applicant: Island Elderly Housing Phone: (508) 693-2781 (SB&H)  
 60B Village Road  
 Oak Bluffs, MA 02557

Date: November 6, 2021  
 designed by: CPA drawn by: CPA checked by: CDH

Schofield, Barbini & Hoehn, Inc.  
 Land Surveying Civil Engineering  
 12 Surveyor's Lane, Box 339  
 Vineyard Haven, Mass. 02568  
 508-693-2781  
 www.sbhinc.net

MV 799



Oak Bluffs  
Harbor  
Watershed

**Farm  
Pond**

Farm Pond  
Watershed