

**NOTE:**

Use Group: 311.2 Moderate Hazard Storage ... S-1

Proposed Gross Building Area - 27,100 sq.ft.

Maximum Floor Area Allowance Per Occupant (Table 1004.1.1)

Function of Space - Warehouses - 500 Gross sq.ft. Per Occupant

Occupant Load = 27,100 sq.ft./500 sq.ft./occ. = 55 Occupants

NOTE: Entire Building will have Fire Protection Sprinkler System

Section 1016 - Exit Access Travel Distance, Use Group S-1 Moderate Hazard Storage, Table 1016.1, Exit Travel Distance allowed with Sprinkler System is 250', Maximum Travel Distance in Proposed Building to Exit is 120 Feet Maximum

Proposed Building to be Construction Classification Type IIB, Noncombustible with Sprinklers - per Table 601

**1 FIRST FLOOR PLAN**  
Scale 1/8" = 1'-0"

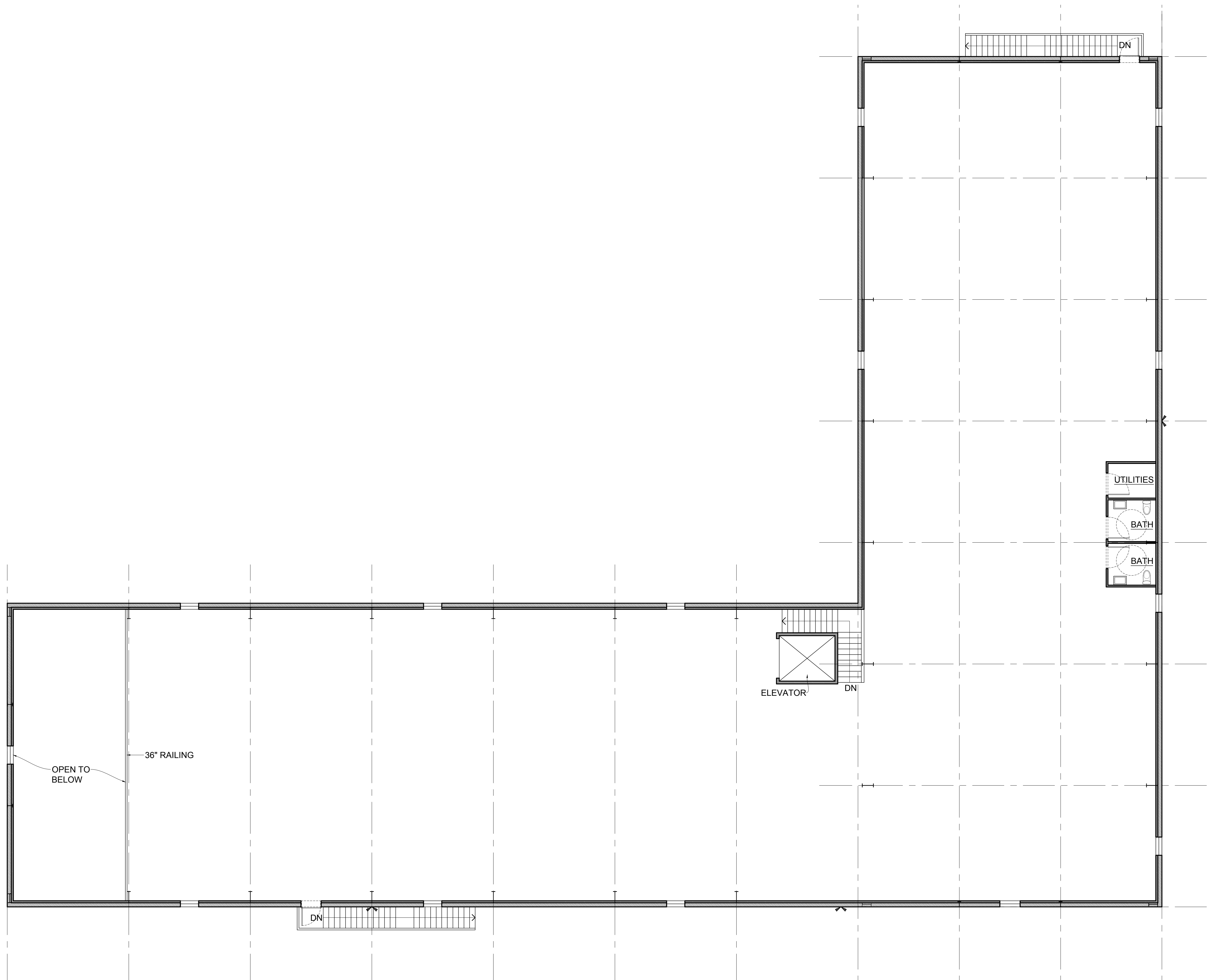

① **SECOND FLOOR PLAN**  
 Scale 1/8" = 1'-0"