

1. Buildings are to be tied into the town sewer
2. The parking area surface is currently black r.a.p.
3. The parking area and Arch Avenue will be improved and maintained with black r.a.p., 50% surface infiltration is assumed for these areas.
2. Based on experience with soils in the area, the proposed leaching basins should handle a 10-year rain storm event through storage and infiltration

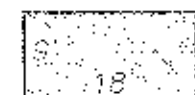

UD 135/9

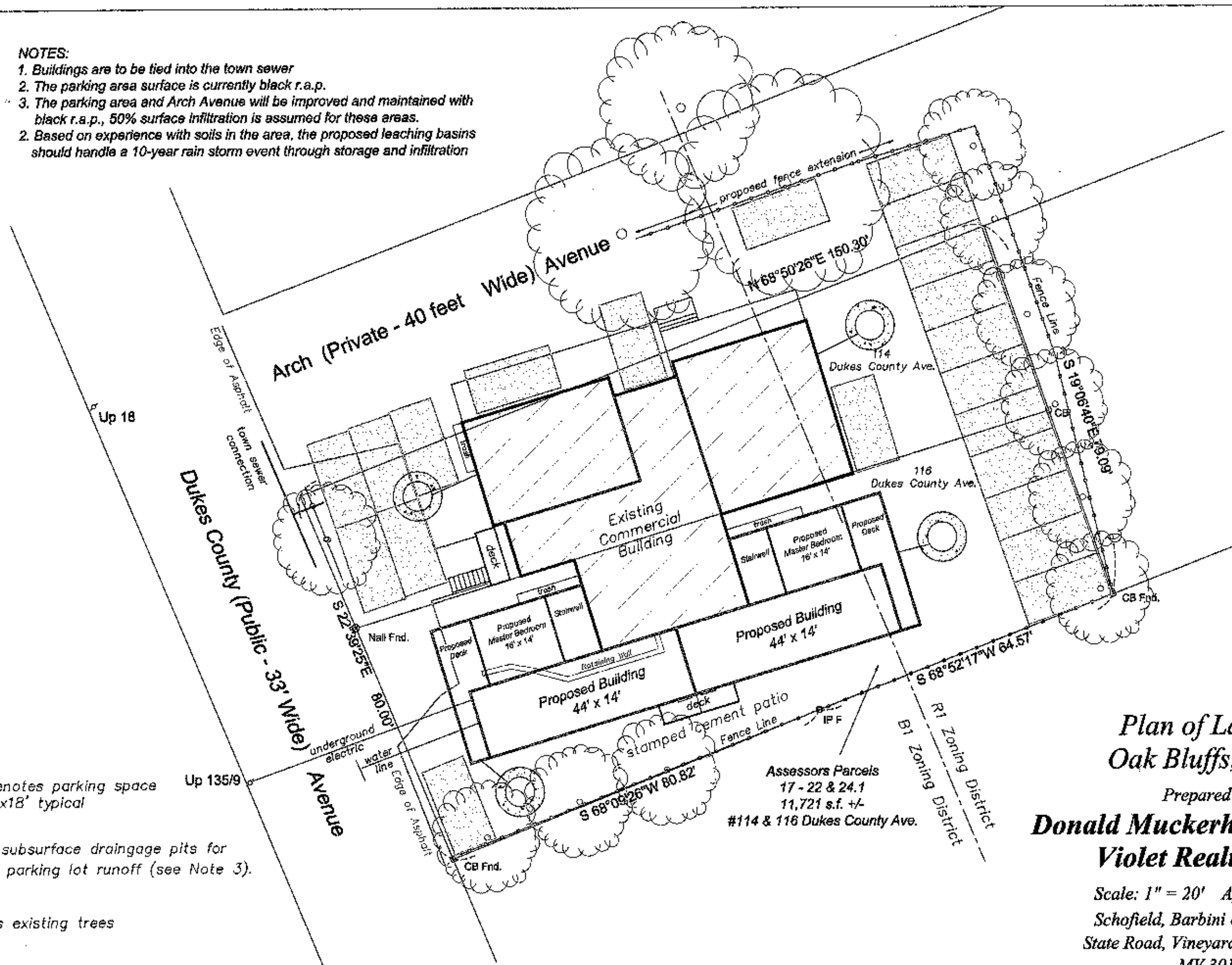

Prepared for

Donald Muckerheide, Trustee
Violet Realty Trust

Scale: 1" = 20' April 16, 2008
Schofield, Barbini & Hoehn Inc.
State Road, Vineyard Haven, Mass.
MV 3010