

PERVIOUS / IMPERVIOUS

| | |
|--|---------------|
| FORMER RESTAURANT* (* Includes Additional Parcel) | |
| PERVIOUS / IMPERVIOUS | 35.6% / 64.4% |
| PROPOSED OCEAN VIEW* (* Includes Additional Parcel) | |
| PERVIOUS / IMPERVIOUS. | 28.8% / 71.2% |

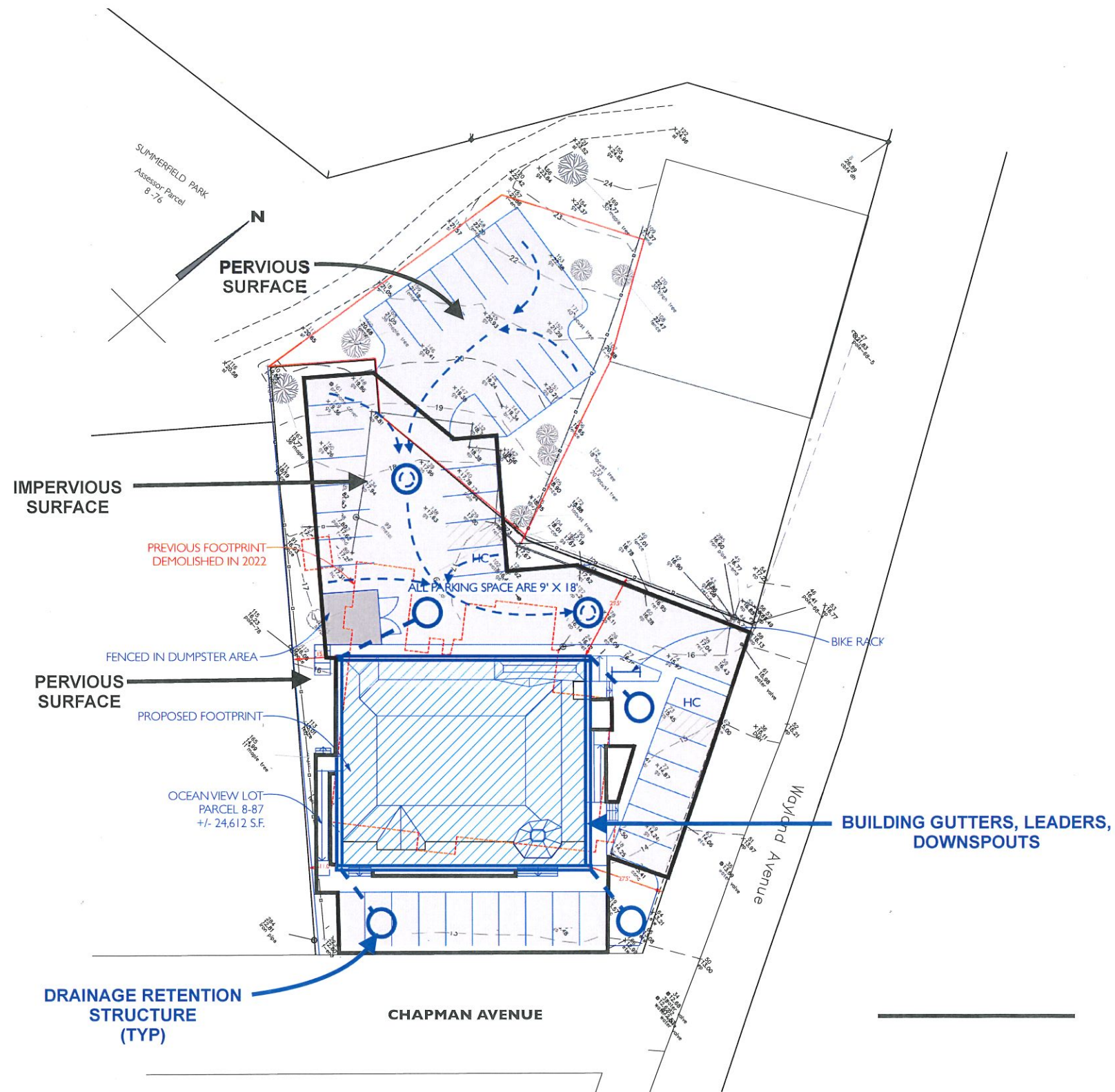

SITE PLAN
SCALE: 1" = 20'

SCHEMATIC DRAINAGE PLAN

SITE PLAN INFORMATION OBTAINED FROM
SITE PLAN BY SOURATI ENGINEERING GROUP LLC.
DATED MAY 2022



| | |
|------|-------|
| SET: | DATE: |
| | |
| | |
| | |
| | |
| | |

| | |
|---------------|--------------------------------|
| PROJECT NAME: | OCEAN VIEW |
| ADDRESS: | 16 CHAPMAN AVE, OAK BLUFFS, MA |
| SHEET TITLE: | SITE PLAN |

| | |
|-------------|------------|
| DRAWN BY: | MT |
| DATE: | 2023-10-23 |
| MAP/PARCEL: | 8-75-0 |
| JOB #: | 22001 |
| DRAWING #: | |

A-002

NOT FOR CONSTRUCTION