

M.T.

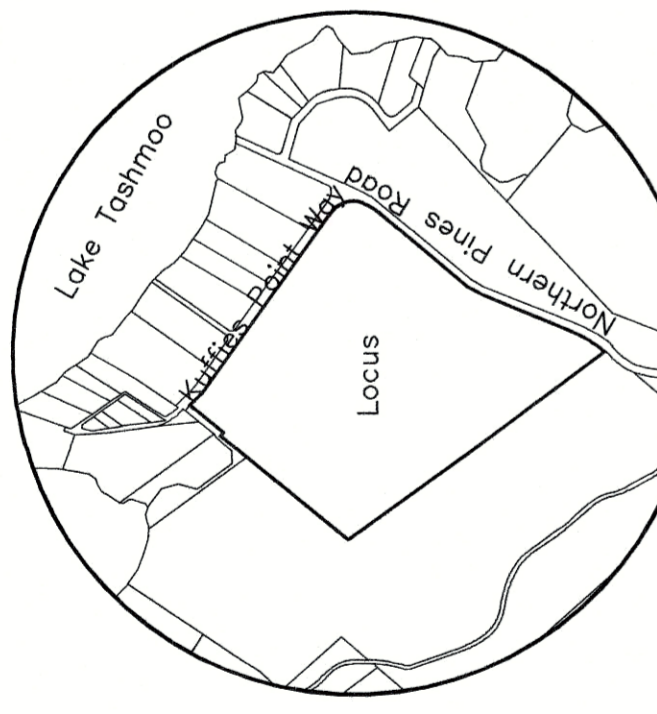

LOCUS MAP
Scale: 1" = 1000'

GRAPHIC SCALE
(IN FEET)
1 inch = 100 ft.

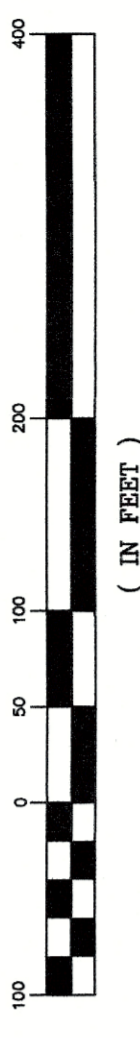

LINE	TABLE
L1	N 25°57'16" E 66.74'
L2	N 64°02'44" W 40.00'
L3	N 25°57'16" E 40.00'
L4	S 64°02'44" E 40.00'

CURVE	TABLE
C1	DELTA 89°46'09" RADIUS 25.00' ARC 39.18'



Assr.-Pcl. 59-B-6
Sheriffs Meadow Foundation Inc.

TOWN OF
TISBURY
PLANNING BOARD
"APPROVED"

Date: _____

I, Hillary Conklin, Clerk of the Town of Tisbury hereby certify that the notice of approval of this plan by the Planning Board has been received and recorded at this office and no notice of appeal was received during the twenty days next after such receipt and recording of said notice.

Town Clerk _____
Date: _____

I certify that this survey and plan were prepared in accordance with the Procedural and Technical Standards for the Practice of Land Surveying in the Commonwealth of Massachusetts.

I certify that this plan has been prepared in conformity with the rules and regulations of the Registers of Deeds of the Commonwealth of Massachusetts.

Date: 1-12-23

 Glenn A. Packer
 Professional Land Surveyor

Being a division of #60 Kuffies Point Way (Assr.-Pcl. 58-A-1)

Deed Reference: Book 1507 Page 271

Plan Reference:
Plan Book 4, Page 45
Book 262 Page 463

Zoning District: R-3A
Minimum Lot Size: 3 Acres
Minimum Frontage: 200'
Setbacks: 50' All Sides

Area Tabulation:

Lots 1 Thru 8 = ±24.08 Acres
 "Agricultural Parcel" "A" = ±16.22 Acres
 Road Lot = ±0.85 Acres
 Total = ±41.15 Acres

Plan of Land in
 Tisbury, Mass.
 Prepared for

Paradise Land Trust,
 John R. & Janet M.
 Packer, Trustees

Scale 1" = 100' January 11, 2023

