

LANDSCAPE DESIGN MODIFICATIONS

PLANT SCHEDULE							
TREES							
BOTANICAL NAME / COMMON NAME	CONT	GAL	SIZE	QTY	REMARKS		
AR	Acer rubrum / Red Maple	B & B	36"box	2			
AM	Amelanchier canadensis / Shadblow Serviceberry	B & B	Multistem	6'	7	Limb up 6'	
IA	Ilex opaca / American Holly	B & B	6'-8'	17			
JE	Juniperus virginiana / Eastern Red Cedar	B & B	5'-6" HT	22			
NS	Nyssa sylvatica / Sour Gum	#15	1"-1.5" Cal	15		Limb up 6'	
QP	Quercus palustris / Pin Oak	B & B	2.5"-3" Cal	8			
SHRUBS							
BOTANICAL NAME / COMMON NAME	CONT	SIZE	QTY	REMARKS			
CH	Clethra alnifolia / Hummingbird / Summersweet	B & B	27				
CG	Cornus racemosa / Gray Dogwood	B & B	4'-6" H	11			
HW	Hydrangea quercifolia / 'Pee Wee' / Oakleaf Hydrangea	5 Gal	20				
IW	Ilex verticillata / Winterberry	B & B	4'-6" H	6		'Plasquam' typically, with (2) 'Jim Dandy'	
MP	Myrica pensylvanica / Northern Bayberry	#5 container	118				
RG	Rhus glabra / Smooth Sumac	5 Gal	13				
SA	Sassafras albidum / Sassafras	7 Gal	11				
ST	Spiraea tomentosa / Sleepybush	5 Gal	13				
VA2	Viburnum dentatum / Viburnum	#3 Container	146				
VA3	Viburnum opulus americanum / American Cranberrybush	B & B	27				
GROUND COVERS							
CODE	BOTANICAL NAME / COMMON NAME	CONT	SPACING	QTY	REMARKS		
AM2	Achillea millefolium / Common Yarrow	1 Gal	12" o.c.	86			
AM3	Anaphalis margaritacea / Pearly Everlasting	1 Gal	24" o.c.	17			
AU	Arctostaphylos uva-ursi / Kinnikinnick	4" pot	12" o.c.	35			
AE	Aster novae-angliae / New England Aster	1 Gal	18" o.c.	73			
DP	Dennstaedtia punctilobula / Hay-scented Fern	4" pot	12" o.c.	2,270			
FS	Festuca ovina / Sheep Fescue	Seed		1,808 sf			
MW	Meadow Seed Mix	seed		36,863 sf			Island Sandplain meadow mix by Carlos Montoya
PD	Penstemon digitalis / Beard-tongue	1 Gal	18" o.c.	42			
SL	Schizachyrium scoparium / Little Bluestem Grass	2" plug	24" o.c.	140			over seed with Festuca ovina, 45 lbs per acre
TR	Turf Reinforced Turf / Reinforced Lawn	flat		13,789 sf			
TS	Turf Sod / Drought Tolerant Fescue Blend	Sod		21,649 sf			
VA	Vaccinium angustifolium / Lowbush Blueberry	Sod		436 sf			from Fred's Wild Sod or approved equal

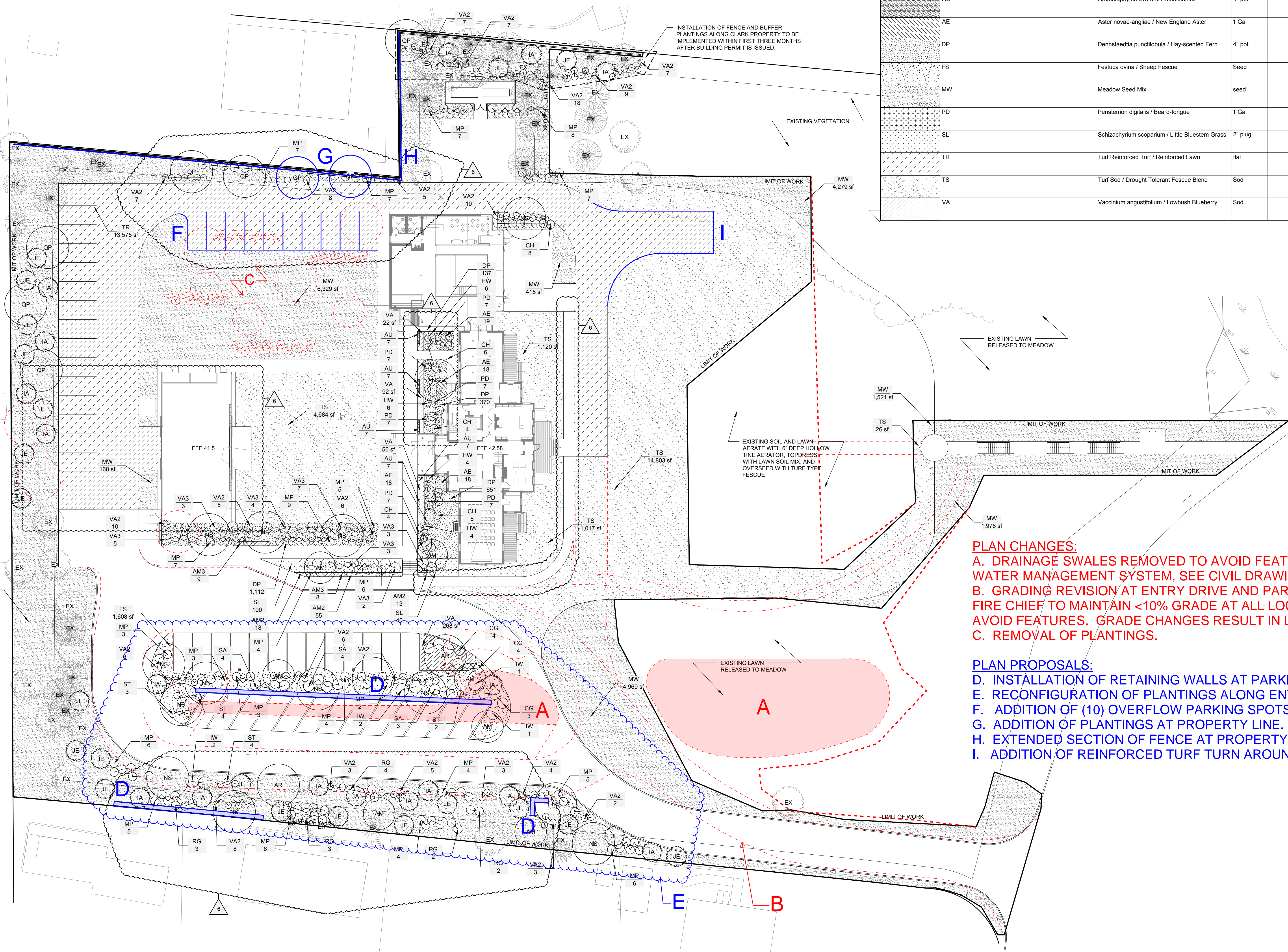

PLAN CHANGES:

- A. DRAINAGE SWALES REMOVED TO AVOID FEATURES. TO BE REPLACED WITH NEW STORM WATER MANAGEMENT SYSTEM, SEE CIVIL DRAWING C.2.
- B. GRADING REVISION AT ENTRY DRIVE AND PARKING LOT TO ACCOMMODATE REQUEST FROM FIRE CHIEF TO MAINTAIN <10% GRADE AT ALL LOCATIONS FOR EMERGENCY VEHICLES AND TO AVOID FEATURES. GRADE CHANGES RESULT IN LOSS OF (4) PARKING SPOTS.
- C. REMOVAL OF PLANTINGS.

PLAN PROPOSALS:

- D. INSTALLATION OF RETAINING WALLS AT PARKING LOT TO ACCOMMODATE GRADING CHANGES.
- E. RECONFIGURATION OF PLANTINGS ALONG ENTRY DRIVE AND PARKING LOT.
- F. ADDITION OF (10) OVERFLOW PARKING SPOTS ON REINFORCED TURF.
- G. ADDITION OF PLANTINGS AT PROPERTY LINE.
- H. EXTENDED SECTION OF FENCE AT PROPERTY LINE REQUESTED BY NEIGHBOR
- I. ADDITION OF REINFORCED TURF TURN AROUND FOR EMERGENCY VEHICLES



Sevan Engineering Group
 T. 603.883.9333
 Stephen Shimon Associates
 T. 617.926.8800
 RBE Associates
 T. 617.926.8000
 Security
 T. 308.673.9334
 Architects Security Group
 T. 617.354.4902
 Lam Partners, Inc.
 T. 617.926.8000
 Scientific
 T. 617.926.8000
 Acoustic Engineering
 T. 617.926.8000
 Code Red
 T. 617.926.8000
 Cost Estimation
 T. 617.451.2717
 Dandaulu
 T. 617.926.8277
 Reim Associates
 T. 617.926.8277

Martha's Vineyard Museum
 151 Lagoon Pond Road, Vineyard Haven, MA
 Oudens Eilo Architecture, LLC
 151 Lagoon Pond Road, Vineyard Haven, MA 02518
 T. 617.422.0800 F. 617.422.0805

Revision:	Date:
100% CD Set	11.11.16
50% CD Set	03.10.17
Bid Set	04.03.17
100% CD Set	06.09.17
Bulletin 1	11.29.17
Bulletin 2	12.12.17
Bulletin 4	1.17.18
Bulletin 5	2.15.18
Bulletin 6	4.02.18

Sheet Title:
PLANTING PLAN

Date: 11.29.17
 Scale: 1" = 20'-0"
 Drawn: ML
 Checked: JW
 Project No: 1506

Sheet No.:
L 5.1