

KENT A. HEALY Sc.D. PE
Civil Engineering
1 Farms End Road
P.O. Box 128
West Tisbury, MA 02575
508-693-6736

May 9, 2019

B. Kostman
South Mountain Co.
PO Box 1260
West Tisbury, MA
02575

Dear Ms. Kostman:

On May 9, 2019, I inspected with you and Newell Shinn, the gray water disposal system that was constructed and installed with the "Clivus" composting waste water treatment system in 1999 to serve the shop and office employees at The South Mountain Company, 15 Red Arrow Rd., AP 8-37, West Tisbury, MA. The system was constructed essentially as shown on the 6/16/99 Kent A. Healy plan, on the south side of the building. The system was designed to absorb 162 gallons of gray water per day. Water use measured for the last several years has averaged 24 gallons per day and the four trenches inspected May 9 showed no sign of ponding or overflow from the gray water use. The proposed increase of water use to 36 gallons per day will be absorbed satisfactorily. I recommend monthly inspection of the trenches. There is area available to expand the system if necessary.



Kent A. Healy
PE MA #28498

SOUTH MOUNTAIN CO
HEAD OF THE POND ROAD
WESTTISBURY MASS

KENT A HEALY 6/16/99
WESTTISBURY MASS
PENG# 28498

SHOP + OFFICE GRAY WATER LEACHING FACILITY
SEE SCHOFIELD BARBINI + HOEHN
6/16/98 PLAN AND HANSON ASSOC. 2/9/99

PLAN 1"=5'

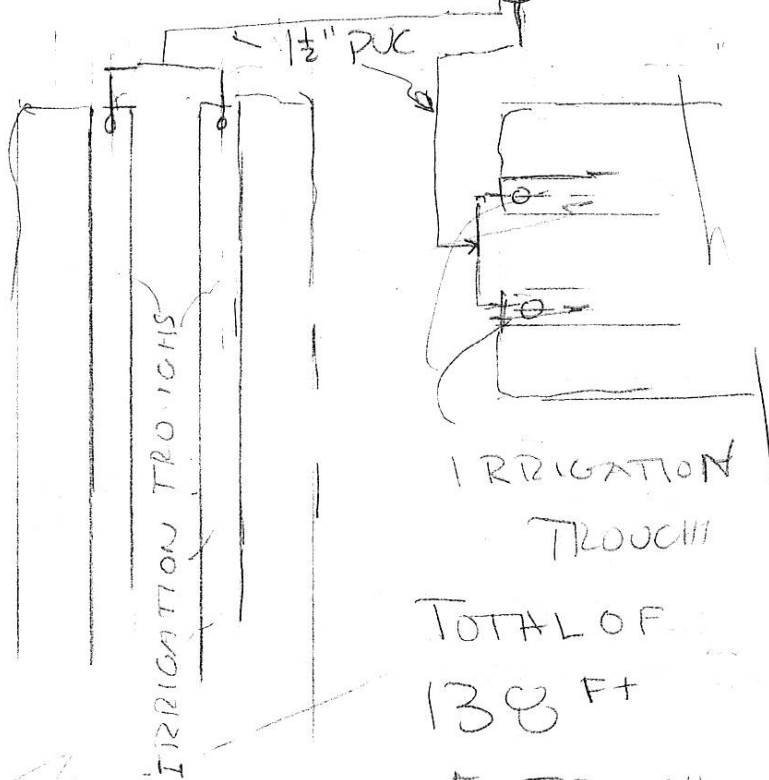

IRRIGATION
TROUGH

TOTAL OF
138 FT
OF TROUGH
REQUIRED

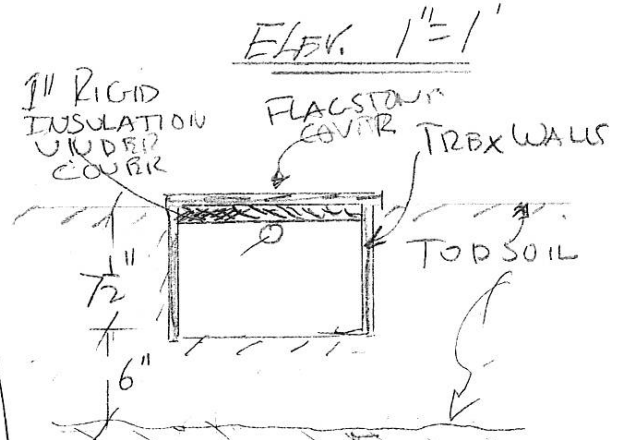

12" OF CLEAN SAND

NATURAL SOIL

DESIGN DATA

$$162 \text{ GPD} / 138 \text{ FT}^2 = 1.17 \text{ GPD/FT}^2$$

LONG TERM ACCEPTANCE RATE
OF GRAY WATER ON
CLEAN SAND IS
2-3 GPD/FT²

ELEV 1"=5'

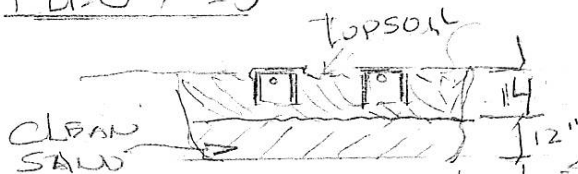

12" OF CLEAN SAND (<4% PASSING #200 SIEVE)
UNDER IRRIGATION TROUCHS
W/ TOPSOIL BETWEEN TROUCHS

NO EQUIPMENT ALLOWED ON
NATURAL SOIL IN EXCAVATION

NATURAL SOIL (C₁)
UNDER SAND

SEE
S+B+H PLAN

