

J:\ENG\MA\WARTHASVINEYARD\13978-CENTRALTRANSFERSTATION\13978A-CIRCULATION\DRAWINGS\CIV\13978A-POST-DEVELOPED.DWG | 13978A-Post-Developed | 1:4.56 | 9/13/2019 10:55:21 AM | RICHARD.BOURGET LAST SAVED BY: RICHARD.BOURGET 9/10/2019 3:57 PM

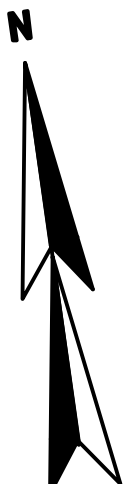
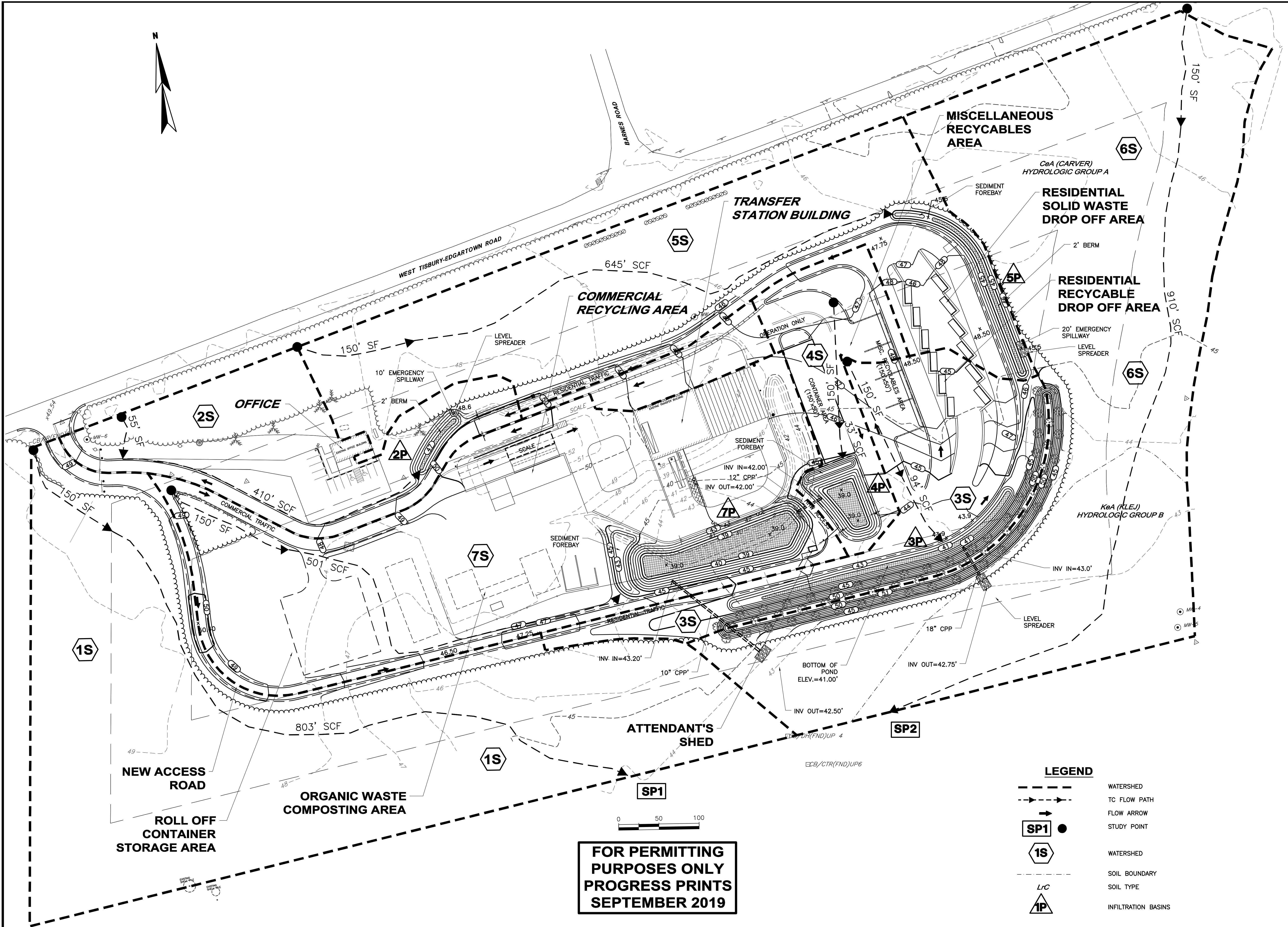

**FOR PERMITTING
PURPOSES ONLY
PROGRESS PRINTS
SEPTEMBER 2019**

LEGEND

	WATERSHED
	TC FLOW PATH
	FLOW ARROW
	STUDY POINT
	WATERSHED
	SOIL BOUNDARY
	SOIL TYPE
	INFILTRATION BASINS

<p>DESIGNED BY: RJB CAD COORD.: RJB CHECKED BY: DATE: APPROVED BY: DATE: 09/18 PROJECT NO: 13978A</p>	<p>DATE: 9/19 DAR: 9/19</p> <p>FOR PERMITTING</p> <p>NO. 1 NO. 2 NO. 3 NO. 4</p> <p>SUBMISSIONS/REVISIONS</p>
<p>WRIGHT-PIERCE Engineering a Better Environment 888.621.8156 www.wright-pierce.com</p>	
<p>MARTHA'S VINEYARD REFUSE DISPOSAL & RESOURCE RECOVERY DISTRICT CENTRAL FACILITY TRANSFER STATION CIRCULATION IMPROVEMENTS</p>	
<p>POST-DEVELOPED DRAINAGE AREA</p>	
<p>DRAWING D-2</p>	