

J:\ENG\MA\MARTHASVINEYARD\13978-CENTRALTRANSFERSTATION\13978-CIRCULATION.DRAWINGS\CIV\13978A-POST-DEVELOPED.DWG | 13978A-Post-Developed | 1:4.56 | 9/24/2019 11:43:13 AM | RICHARD.BOURGETLAST SAVED BY: RICHARD.BOURGET 9/13/2019 10:55 AM

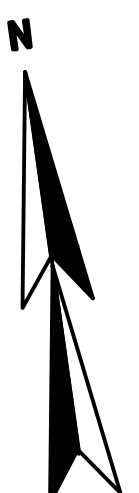
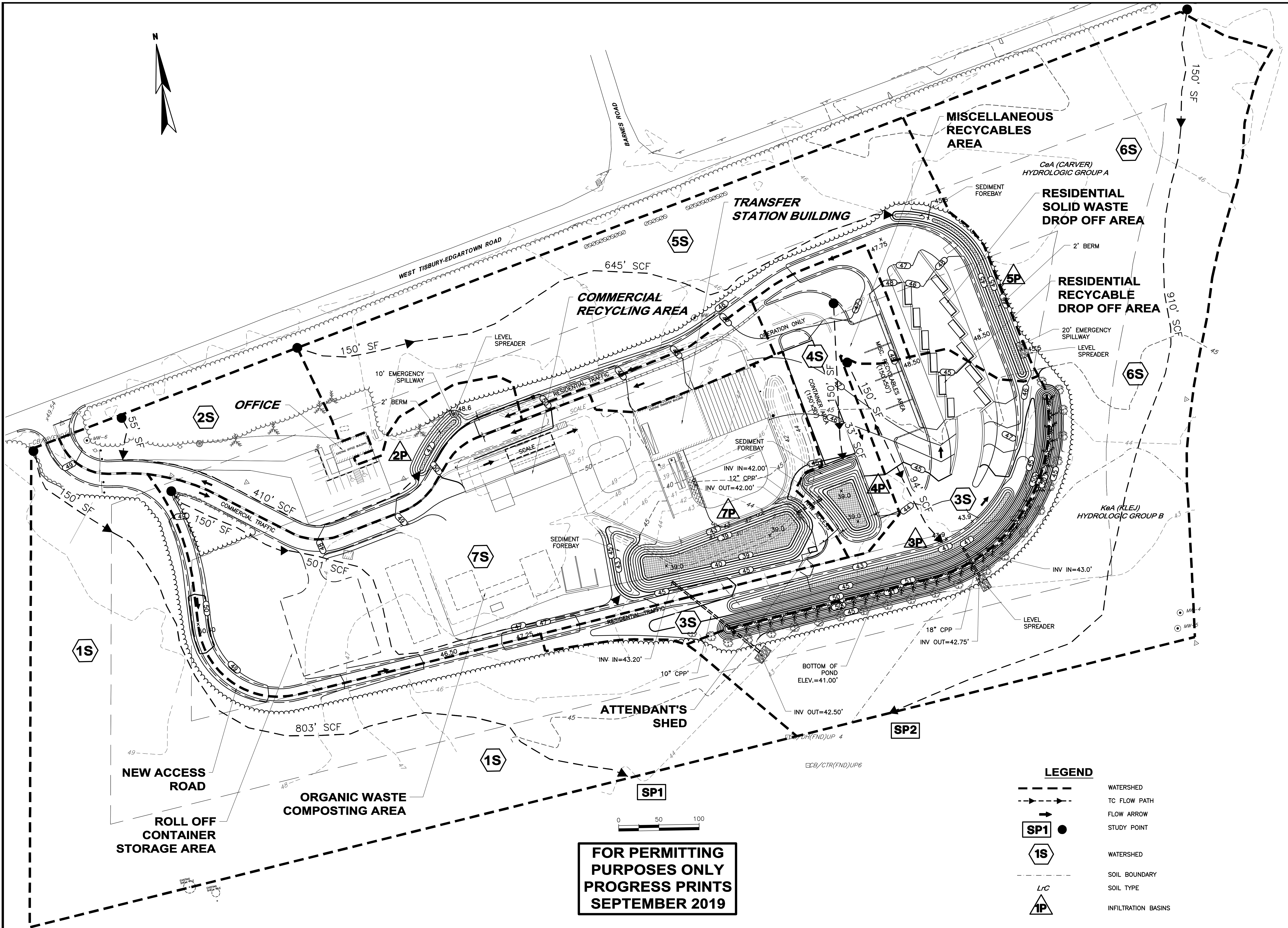

**FOR PERMITTING PURPOSES ONLY
PROGRESS PRINTS
SEPTEMBER 2019**

LEGEND

	WATERSHED
	TC FLOW PATH
	FLOW ARROW
	STUDY POINT
	WATERSHED
	SOIL BOUNDARY
	SOIL TYPE
	INFILTRATION BASINS

SUBMISSIONS/REVISIONS	
NO.	REVISION PER COMMISSION COMMENTS
DESIGNED BY:	RJB
CAD. COORD.:	RJB
CHECKED BY:	
DATE:	09/18
APPROVED BY:	
DATE:	09/18
PROJECT NO.:	13978A
<p>WRIGHT-PIERCE Engineering a Better Environment 888.621.8156 www.wright-pierce.com</p>	
<p>MARTHA'S VINEYARD REFUSE DISPOSAL & RESOURCE RECOVERY DISTRICT CENTRAL FACILITY TRANSFER STATION CIRCULATION IMPROVEMENTS</p>	
<p>POST-DEVELOPED DRAINAGE AREA</p>	
<p>DRAWING D-2</p>	