

PROPOSED MAINTENANCE DREDGE NOTES:

1. PROPOSED MAINTENANCE DREDGE VOLUME (TO GRADE) = 2,350 C.Y.
2. PROPOSED MAINTENANCE DREDGE VOLUME (TO 1FT OVER-DIG) = 4,700 C.Y.
3. PROPOSED DREDGE DEPTH = -4FT MLW. = -5.2FT NAVD88 (WITH 1FT OVERDIG)
4. PROPOSED DREDGE FOOTPRINT = 74,086 S.F.
5. PROPOSED DREDGE TEMPLATES DESIGNED ON A 3:1 SLOPE FROM THE INTERSECTION OF THE PROPOSED DREDGE FOOTPRINT AND EXISTING GRADE TO THE PROPOSED DREDGE DEPTH OF -4FT MLW.
6. DREDGING TO COMPLETED BY MECHANICAL MEANS OR BY HYDRAULIC CUTTER SUCTION DREDGE. IF A MECHANICAL DREDGE IS USED, THE DE-WATERING AREAS SHOWN ON THE SITE PLAN WILL BE USED. (REFER TO THE TYPICAL CONTAINMENT AREA DESIGN FOR MORE DETAILS). AFTER THE DREDGED SEDIMENT IS DE-WATERED, IT WILL BE RE-USED ON SITE TO RE-GRADE PARKING LOT AND SURROUNDING AREA. (PARKING PLAN TO BE FILED UNDER SEPARATE APPLICATION).

PROPOSED FLOATING DOCK AREAS:

1. NORTHERN BOAT SLIP FLOATING DOCKS = 2,084 S.F.
 2. SOUTHERN BOAT SLIP FLOATING DOCKS = 2,855 S.F.
 3. RAMP ACCESS FLOATS (2) = 168 S.F.
- CUMULATIVE AREA OF PROPOSED FLOATING DOCKS = 5,107 S.F.

SEASONAL STORAGE OF FLOATING DOCK:

PROPOSED FLOATING DOCKS TO BE STORED AT MARTHA'S VINEYARD SHIPYARD'S STORAGE LOT AT THE AIRPORT BUSINESS PARK DURING THE OFF-SEASON.

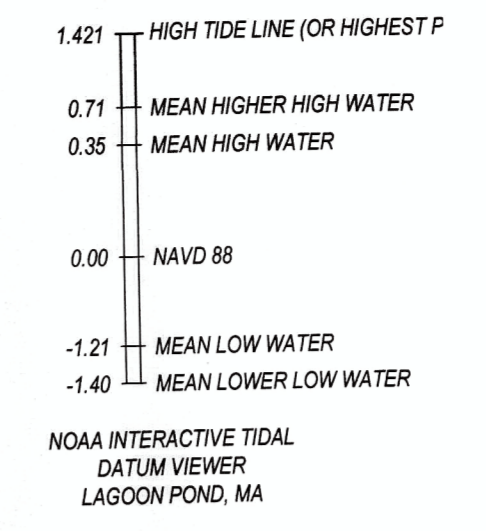

REFERENCE:

ASSESSORS MAP 9, PARCELS 32 AND 33
 PLAN BOOK 299, PAGE 301
 PLAN BOOK 241, PAGE 575

FLOOD ZONE:

FLOOD ZONE AE (EL. 10) AS SHOWN ON FEMA FIRM PANEL #25007C0104J REVISED JULY 20, 2016

DATUM:

ELEVATIONS SHOWN HEREON ARE BASED ON THE NORTH AMERICAN VERTICAL DATUM OF 1988 (NAVD 1988)

HYDROGRAPHIC SURVEY:

1. THE HYDROGRAPHIC SURVEY DATA AS SHOWN ON THIS PLAN WAS COLLECTED ON FEBRUARY 05, 2019 BY COASTAL ENGINEERING COMPANY AND ONLY REPRESENTS THE SEA FLOOR DEPTH AS IT EXISTED DURING THE TIME OF THE SURVEY.

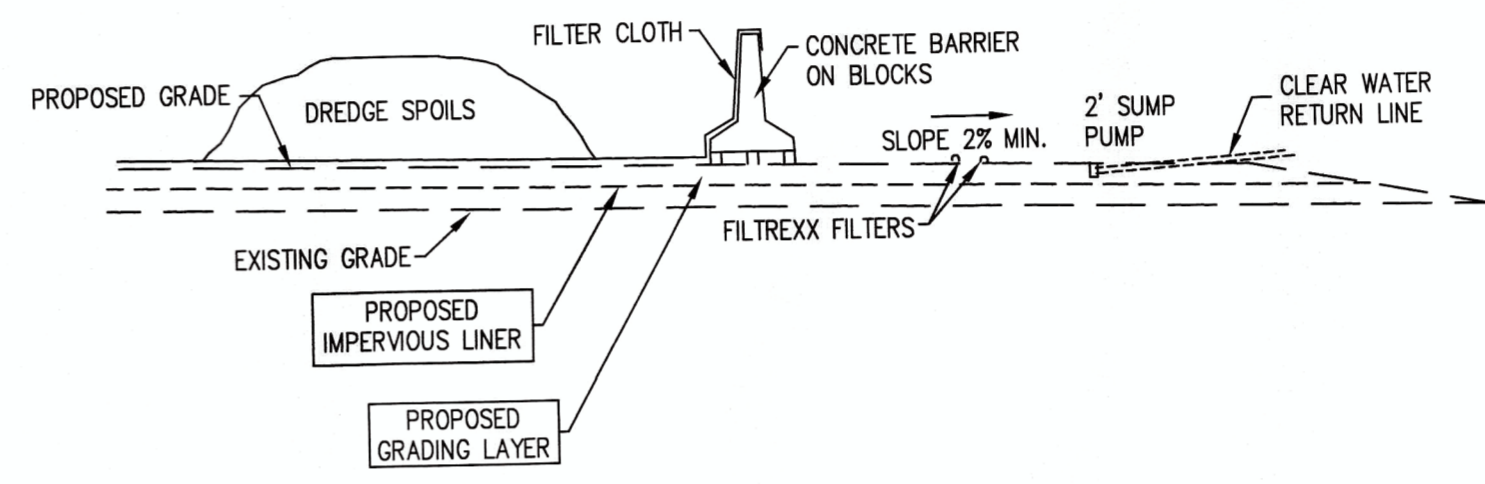

TYPICAL CONTAINMENT AREA DESIGN
NOT TO SCALE

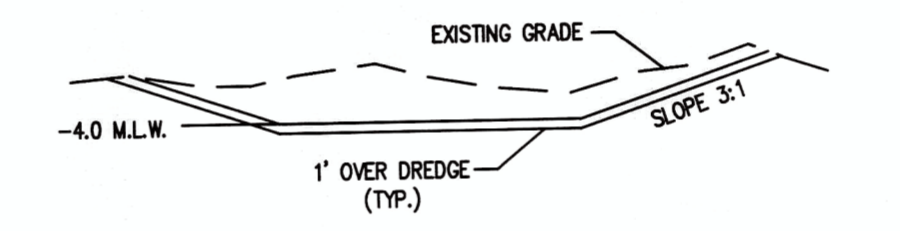

TYPICAL DREDGE PROFILE
NOT TO SCALE

LEGEND

- | EXISTING | |
|-----------|----------------|
| ■ | BOUND |
| — | PROPERTY LINE |
| - - - | MAJOR CONTOUR |
| - · - · - | MINOR CONTOUR |
| WV | WATER VALVE |
| □ | PULL BOX |
| □ | ELECTRIC METER |
| ■ | CATCH BASIN |
| OHW | OVERHEAD WIRES |
| ○ | UTILITY POLE |
| ⊙ | POST |
| ⊕ | MISC. MANHOLE |
| - x - | FENCE |

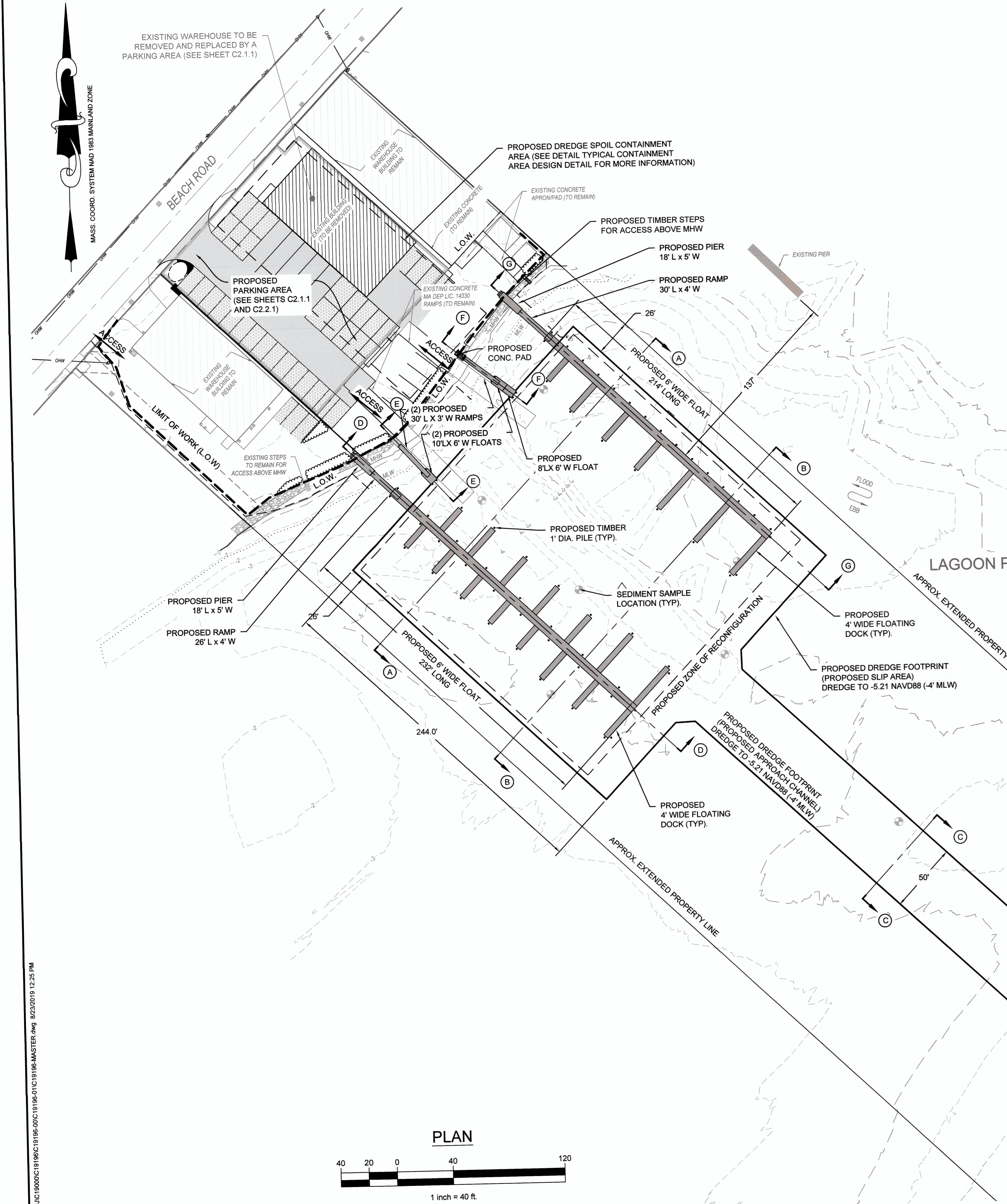

PLAN

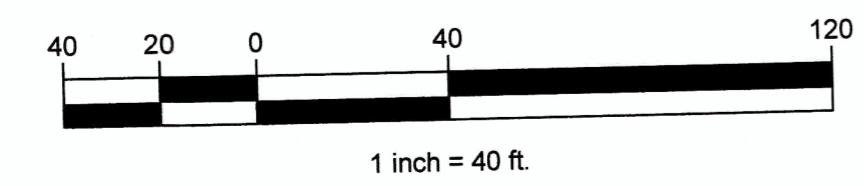

F:\BDSK\PROJ\1906\019196\C19196-01\C19196-MASTER.dwg 8/22/2019 12:25 PM

NO.	DATE	REVISION

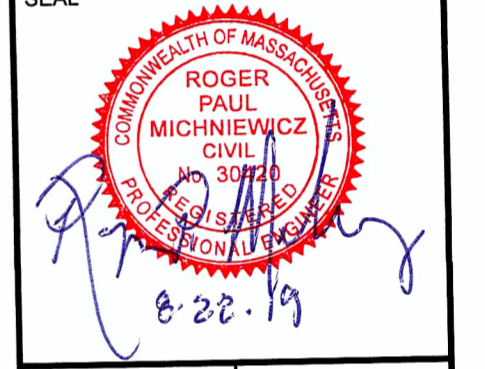

MARTHA'S VINEYARD SHIPYARD
 TISBURY, MA
 159 AND 173 BEACH ROAD
 SHEET TITLE
PROPOSED MARINA

PROJECT: MARTHA'S VINEYARD SHIPYARD
 SCALE: AS NOTED
 DRAWING FILE: C:\19196-MASTER.dwg
 DATE: 08/22/2019
 DRAWN BY: CAA
 CHECKED BY: RPM

C3.1.1
 OF SHEETS
 PROJECT NO. C19196.01