

October 26, 2016

4 Alwardt Way, Oak Bluffs, MA
Responses to MVC Questions following DRI 660 Public Hearing

1. What is the current electricity usage of the O.B. Water District? At the public hearing it was stated that the annual Oak Bluffs Water Department power bill is \$100,000 year. What does that translate to in Kilowatts or Megawatts? Can you provide the bill?

The Oak Bluffs Water District annual electricity usage is approximately 500,000 kWh. The current Eversource tariff governs the base rate of electricity on Martha's Vineyard. The base rate varies, but is currently about \$0.175/kWh. This number doesn't include typical additional demand charges. This base rate would equate to approximately \$87,500 per year in electricity bills for the Water District. The Water District spent approximately \$100,000 on electricity last year once you add in the additional demand charges.

The proposed array will be able to supply all of the Water District's electricity load at a discounted rate. As the demand on the Town's water infrastructure is increasing over time, the Water District is already scouting new well sites to expand their production. New wells means increased electricity usage, and potentially higher rates for the residents of Oak Bluffs. The installation of this solar array will work to counteract that increase, and any required increases in the future.

2. Would any excess energy produced by the project be reserved for any particular user or type of user? Would it be discounted? If so, how much?

The excess electricity is being sold to a private entity and the terms of the deal are confidential.

3. Can you clarify the acreage breakdown of the areas with clearing, stumping and re-grading and the areas to be cleared without stumping in the project both within the fence and outside of the fence in the Zone 1 and the Zone 2?

Please reference the included sketch plans prepared by Sourati Engineering Group.

- a. Is the entire area inside the fence going to have the stumps removed and the land regraded for the required drainage? How many acres are to be cleared and stumped and regraded within the fenced in areas?

Zone 1:** Within the fence, there will be ± 0.19 acres requiring stump removal. There will be **no grading within Zone 1.

BLUE WAVE

5. What is the form of the contract or permission by which BWC Wankinco River LLC (a wholly owned subsidiary of BlueWave Capital LLC) would operate on the O.B. Water District land?

SunEdison has a leasehold interest in the project site at 4 Alwardt Way, owned by the Oak Bluffs Water District. BlueWave (BWC Wankinco River, LLC) is partnered with SunEdison on this project to assist with the permitting and development of the project. SunEdison will be the long-term owner and operator of the system.

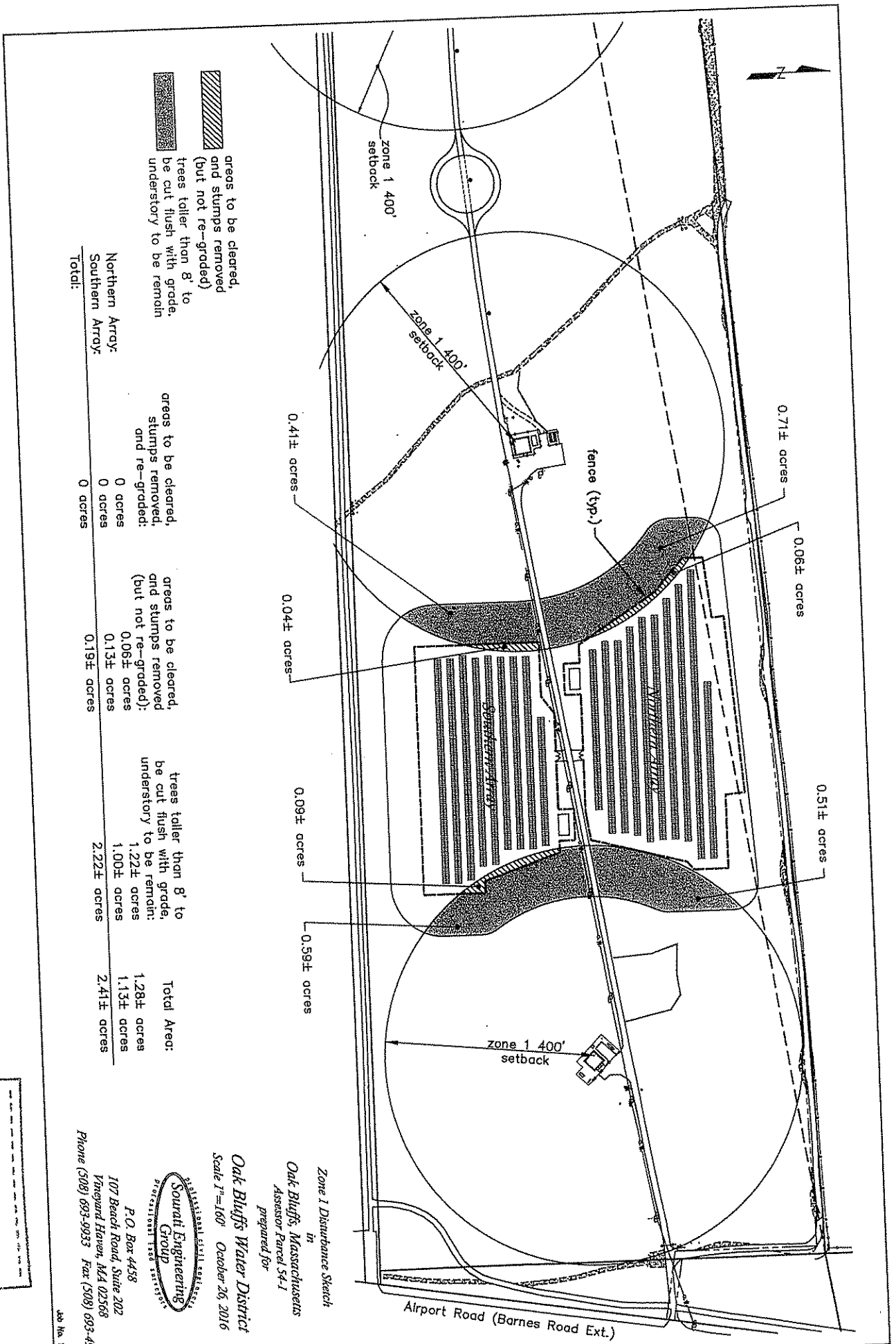

areas to be cleared, and stumps removed (but not re-graded)

trees taller than 8' to be cut flush with grade, understorey to be remain

areas to be cleared, stumps removed, and re-graded:

areas to be cleared, and stumps removed, (but not re-graded):

trees taller than 8' to be cut flush with grade, understorey to be remain:

Total Area:

Northern Array: 0 acres
 Southern Array: 0 acres
Total: 0 acres

0 acres
 0.06± acres
 0.13± acres
Total: 0.19± acres

1.22± acres
 1.00± acres
Total: 2.22± acres

1.28± acres
 1.13± acres
Total: 2.41± acres

Zone 1 Disturbance Sketch
 in
 Oak Bluffs, Massachusetts
 Assessor Parcel 54-1
 prepared for

Oak Bluffs Water District
 Scale 1"=160' October 26, 2016

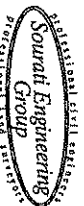

P.O. Box 4458
 107 Beach Road, Suite 202
 Vineyard Haven, MA 02568
 Phone (508) 693-9933 Fax (508) 693-40-

RECEIVED

502 07 130

RECEIVED
OCT 28 2016

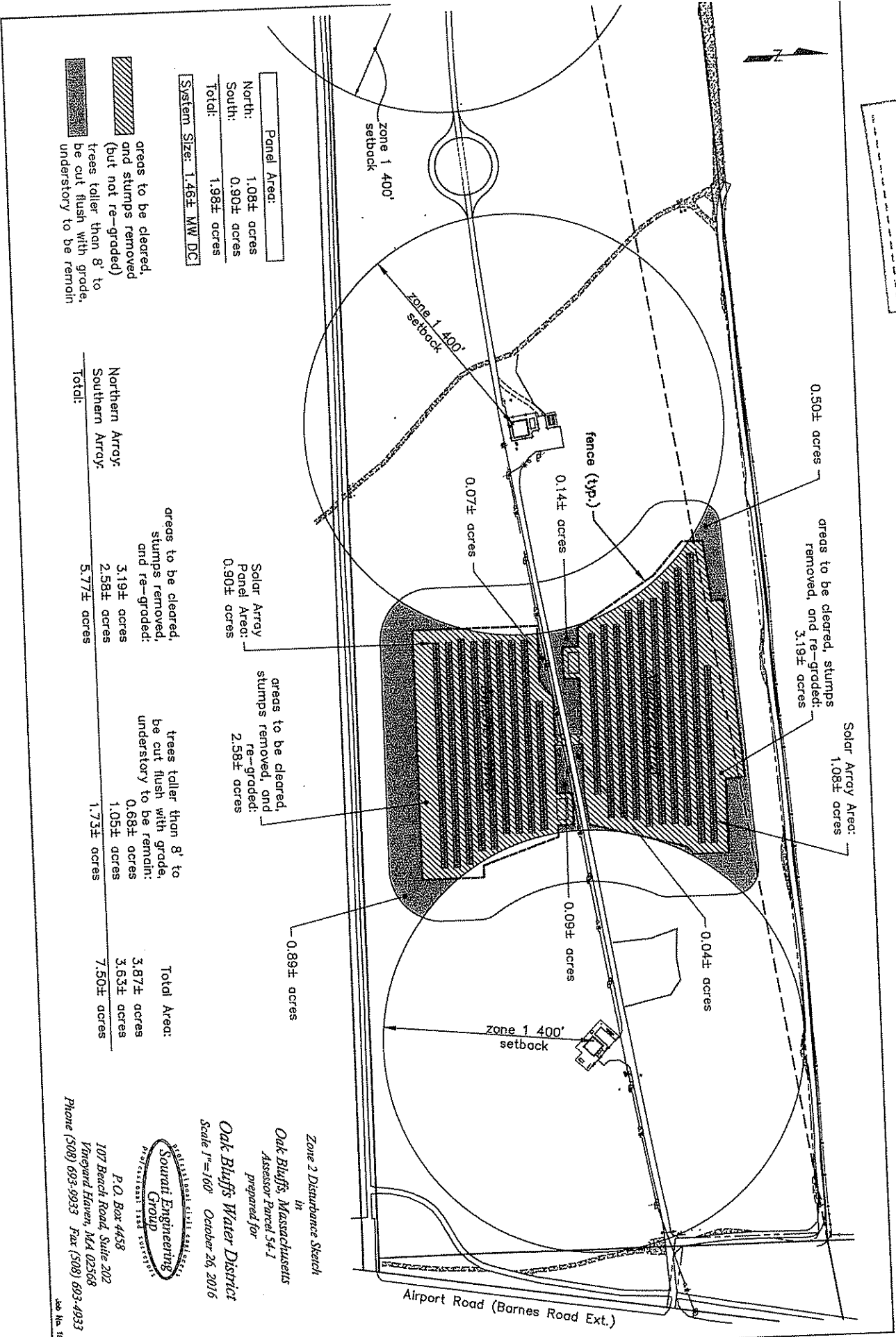

Panel Area:
North: 1.08± acres
South: 0.90± acres
Total: 1.98± acres
System Size: 1.46± MW DC

areas to be cleared, and stumps removed (but not re-graded) trees taller than 8' to be cut flush with grade, understorey to be remain

0.50± acres areas to be cleared, stumps removed, and re-graded: 3.19± acres
Solar Array Area: 1.08± acres
Solar Array Panel Area: 0.90± acres
0.14± acres fences (typ.)
0.07± acres
0.04± acres
0.09± acres
zone 1 400' setback
zone 1 400' setback
0.89± acres
0.04± acres
0.09± acres
zone 1 400' setback
Airport Road (Barnes Road Ext.)

areas to be cleared, stumps removed, and re-graded: 2.58± acres
trees taller than 8' to be cut flush with grade, understorey to be remain: 1.05± acres
Northern Array: 3.19± acres
Southern Array: 2.58± acres
Total: 5.77± acres

areas to be cleared, stumps removed, and re-graded: 2.58± acres
trees taller than 8' to be cut flush with grade, understorey to be remain: 1.05± acres
Total Area: 3.63± acres
7.50± acres

Zone 2 Disturbance Sketch
in
Oak Bluffs, Massachusetts
Assessor Parcel 54-1
prepared for
Oak Bluffs Water District
Scale 1"=160' October 26, 2016

Southern Engineering Group
P.O. Box 4458
107 Beach Road, Suite 202
Fringed Haven, MA 02568
Phone (508) 693-9933 Fax (508) 693-9933

RECEIVED
OCT 28 2016

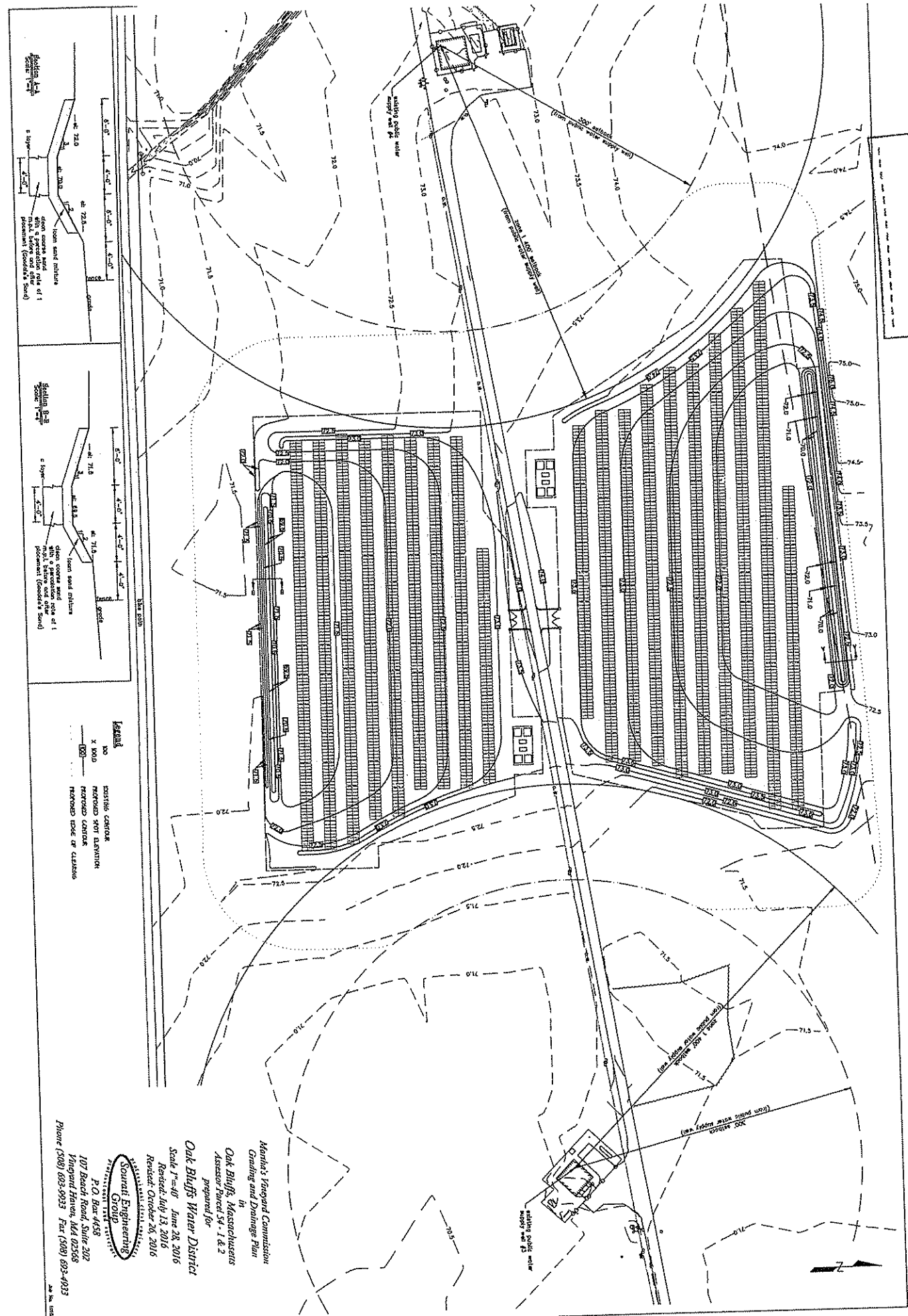

Legend

- EXISTING CURB
- PROPOSED CURB
- PROPOSED SIDE OF CURB
- PROPOSED SIDE OF CURB

Martha's Vineyard Commission
Grading and Drainage Plan
in
Oak Bluffs, Massachusetts
Assessor Parcel 54 - 1 & 2
prepared for
Oak Bluffs Water District
Scale: 1"=40' June 28, 2016
Revised: July 13, 2016
Revised: October 26, 2016

Sourani Engineering Group
P.O. Box 4438
107 Beach Road, Suite 202
Vineyard Haven, MA 02558
Phone (508) 693-9535 Fax (508) 693-4033