

Main Street

Mass. State Highway

10 State Road  
Condominium  
10 State Road  
Assessor's Parcel  
9 A 5.1, 5.2

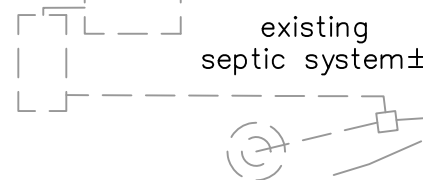
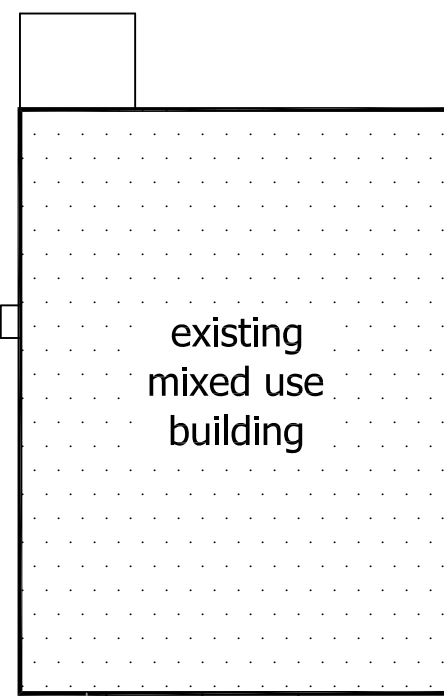

Doreen F. Kinsman, Trs.  
5 Beach Street  
Assessor's Parcel  
9 A 7

Notes:

1. The property is located in the B1 Zoning District.
2. The Tisbury Conservation Commission has jurisdiction over land within the FEMA 100 year storm zone and land within 100 feet of the FEMA 100 year storm zone.
3. CB F = concrete bound found  
SB F = stone bound found

4 State Road  
Assessor's Parcel  
9 A 6  
21,818 s.f.±  
(0.50 acres)

Town of Tisbury  
10 Causeway Road  
Assessor's Parcel  
9 A 41

Access Easement  
12 ft. wide

FEMA  
100 year storm  
Zone AE elev 10  
(approx - to be  
field verified)

**Preliminary**  
**Site Plan**  
**Tisbury, Mass.**

Prepared For  
**4 State Road MVY LLC**

Scale: 1" = 20' July 8, 2021

Town of Tisbury  
10 Causeway Road  
Assessor's Parcel  
9 A 41

 **Schofield, Barbini & Hoehn Inc.**   
Land Surveying & Civil Engineering  
12 Surveyor's Lane, Box 339  
Vineyard Haven, Mass.  
508-693-2781  
www.sbhinc.net  
MV 3736