

CONSTRUCTION DETAIL

SKETCH

Element	Cd.	Ch.	Description	Element	Cd.	Ch.	Description
Building Type	11		Family Conver.	Commercial Data Elements			
Model	01		Residential				
Grade	06		Good	Heat & AC			
Stories	2		2 Stories	Frame Type			
Occupancy	01			Baths/Plumbing			
Exterior Wall 1	14		Wood Shingle	Ceiling/Wall			
2	11		Clapboard	Rooms/Prtns			
Roof Structure	03		Gable/Hip	% Common Wall			
Roof Cover	03		Asph/F Gls/Cmp	Wall Height			
Interior Wall 1	02		Wall Brd/Wood	CONDO/MOBILE HOME DATA			
2				Element	Code	Description	Factor
Interior Floor 1	09		Pine/Soft Wood	Complex			
2				Floor Adj			
Heating Fuel	01		Coal or Wood	Unit Location			
Heating Type	01		None	Number of Units			
AC Type	01		None	Number of Levels			
Bedrooms	05		5 Bedrooms	% Ownership			
Bathrooms	4		4 Bathrooms	COST/MARKET VALUATION			
Total Rooms				Unadj. Base Rate		94.00	
Bath Type				Size Adj. Factor		0.90322	
Kitchen Style				Grade (Q) Index		1.28	
				Adj. Base Rate		108.68	
				Bldg. Value New		270,396	
				Year Built		1880	
				Eff. Year Built		1946	
				Nrml Physcl Dep		55	
				Functl Obslnc		0	
				Econ Obslnc		0	
				Specl. Cond. Code		AP	
				Specl Cond %		10	
				Overall % Cond.		35	
				Deprec. Bldg Value		94,600	

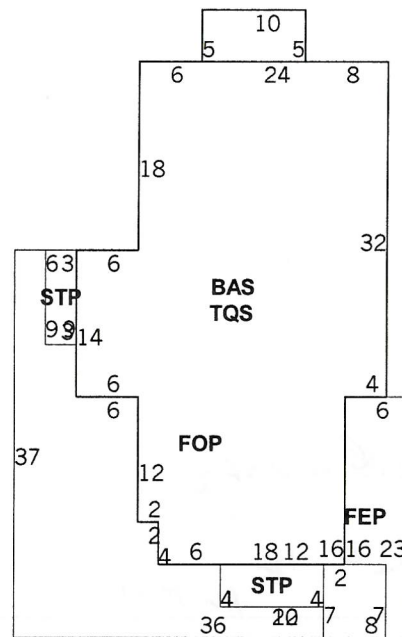

MIXED USE

Code	Description	Percentage
1010	Single Fam	100

OB-OUTBUILDING & YARD ITEMS(L) / XF-BUILDING EXTRA FEATURES(B)

Code	Description	L/B	Units	Unit Price	Yr.	Dp Rt	%Cnd	Apr. Value
FPL3	2 STORY CHIM	B	1	5,600.00	1946	1	100	2,500

BUILDING SUB-AREA SUMMARY SECTION

Code	Description	Living Area	Gross Area	Eff. Area	Unit Cost	Undeprec. Value
BAS	First Floor	1,214	1,214	1,214	108.68	131,938
FEP	Porch, Enclosed, Framed	0	152	106	75.79	11,520
FOP	Porch, Open, Finished	0	536	107	21.70	11,629
STP	Stoop	0	67	13	21.09	1,413
TQS	Three Quarter Story	1,048	1,164	1,048	97.85	113,897
Til. Gross Liv/Lease Area		2,262	3,133	2,488	Bldg Val:	270,396